



# **Assembly Instructions**

## Important information:

1. The kit may come with two main shafts, one long and one short. The short shaft is used for closed (wrap-around handguards) and the long shaft is used for open hand guards that mount over the master cylinder (page 7).
2. Try to rotate the master cylinder upwards for better ergonomics during installation.
3. Grease components and surfaces that have friction.
4. Tools for installation: (7mm, 8mm, 10mm Open Wrench, 10mm Socket, Flat Screwdriver, 2mm, 4mm Allen Key)

# Hardware Provided with the Kit:

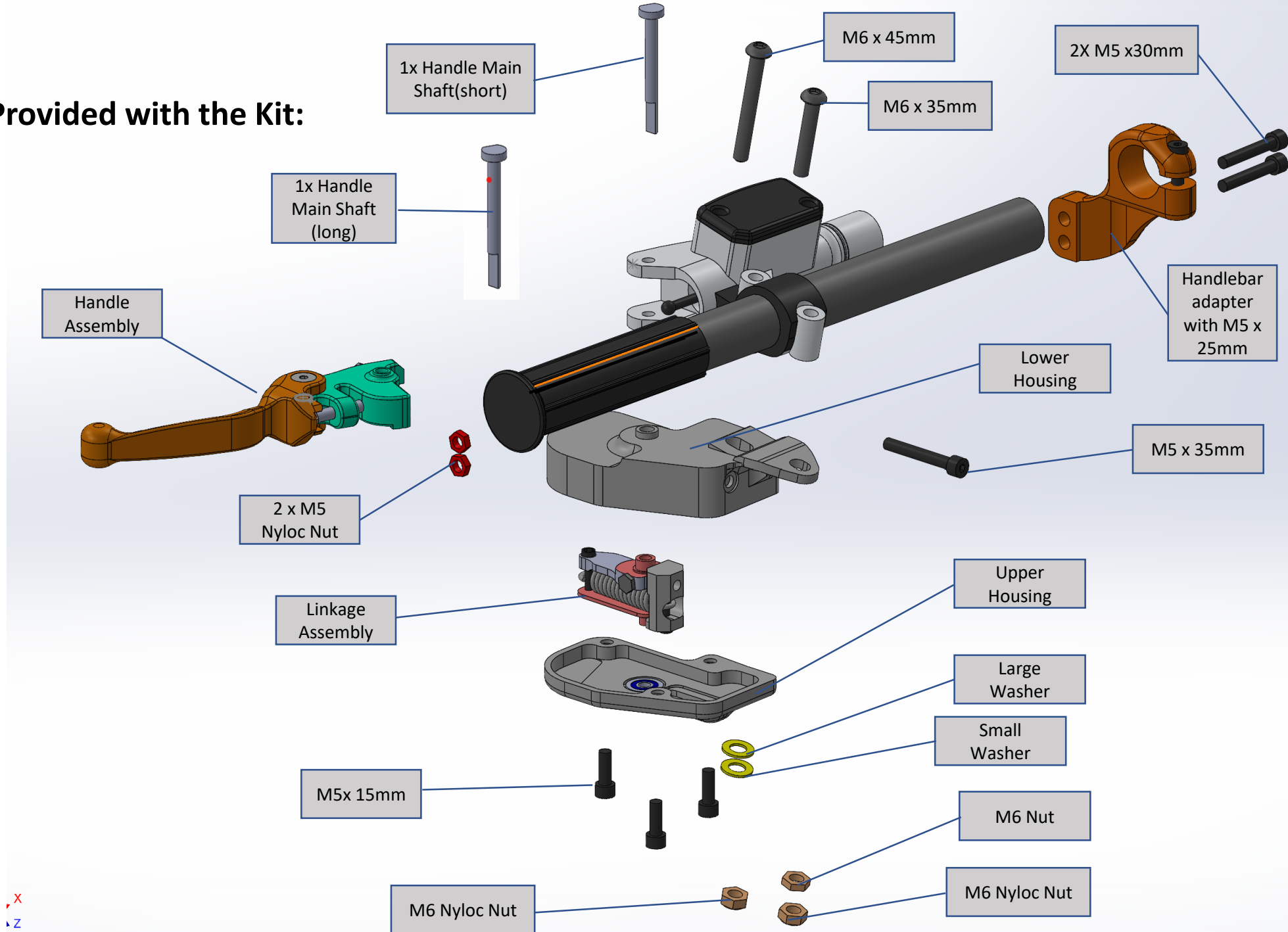

**Step 1:** Remove all accessories from handlebar-clutch side, insert handlebar adapter according to illustrations.

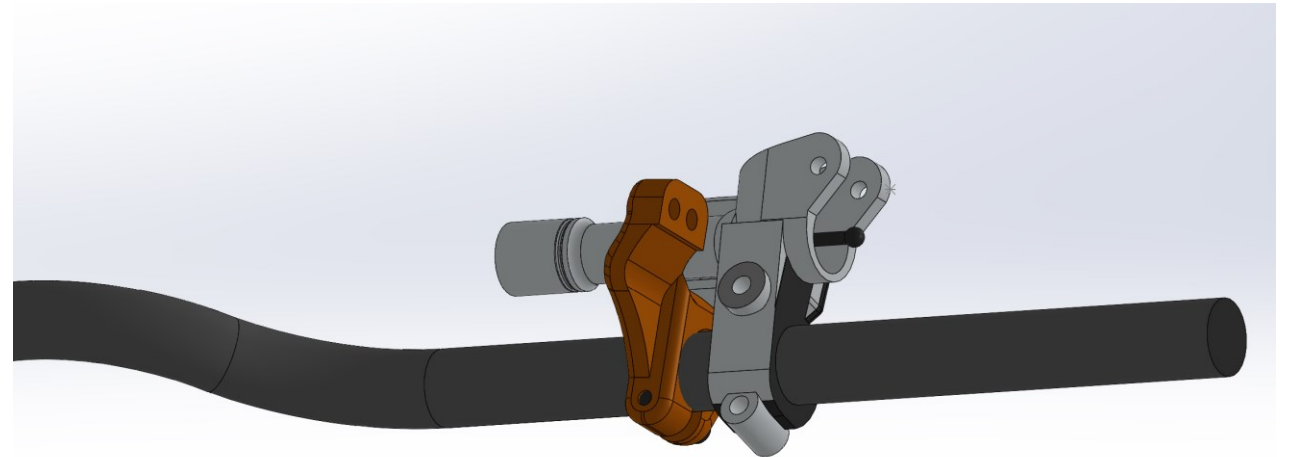
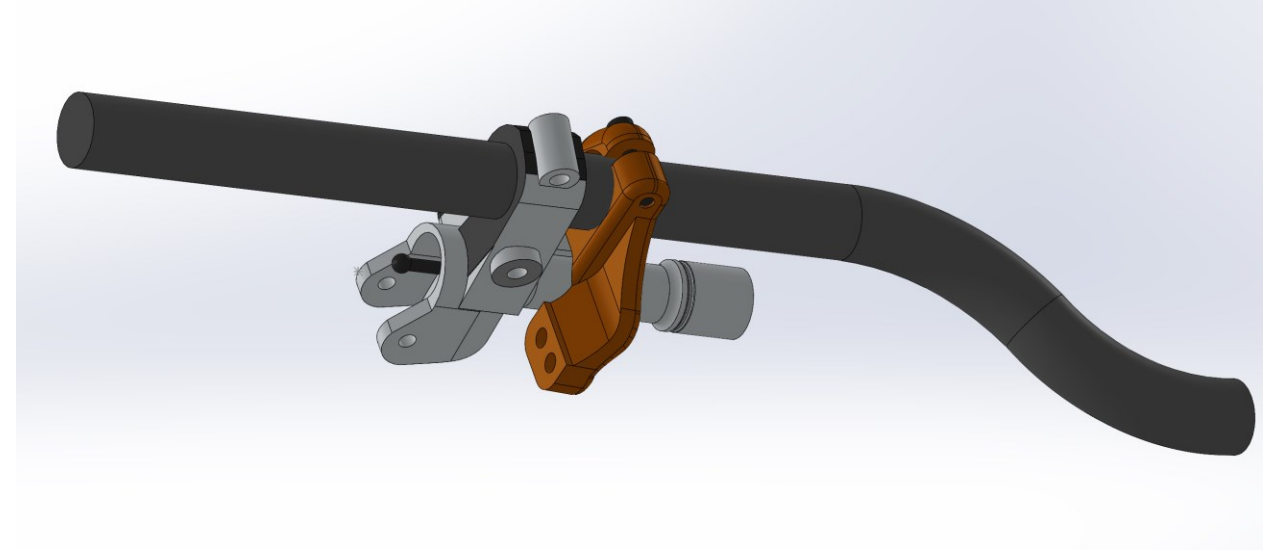
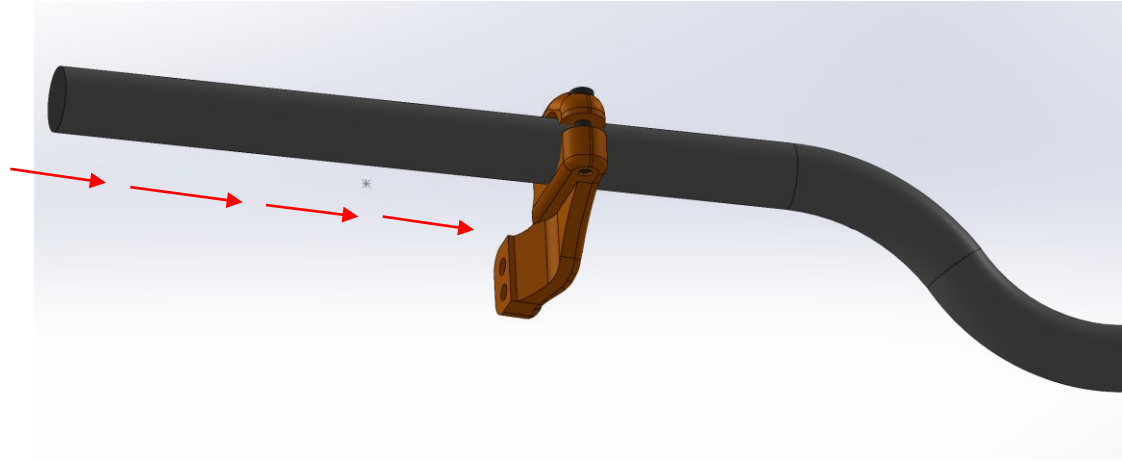

**Step 2:** Assemble clutch pump with the M6 bolts according to illustration, grease master cylinder piston round tip.

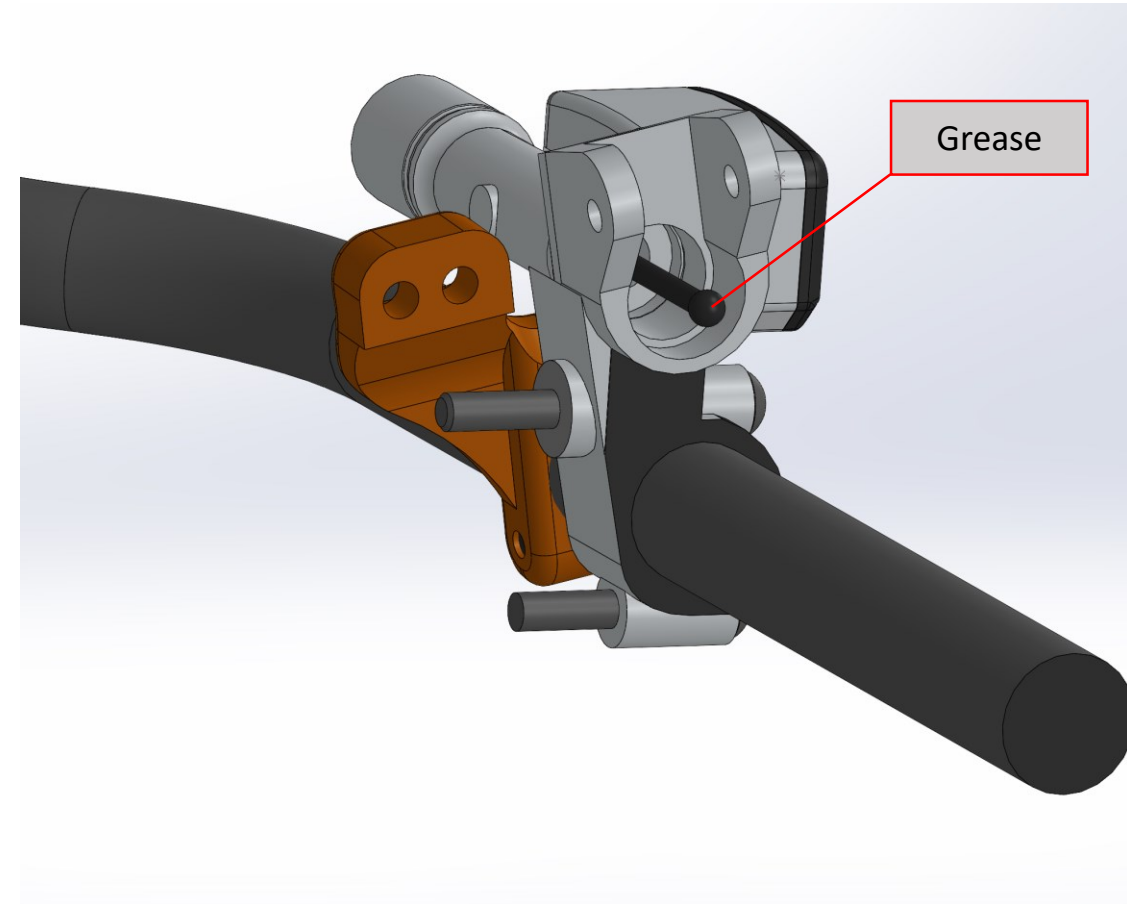
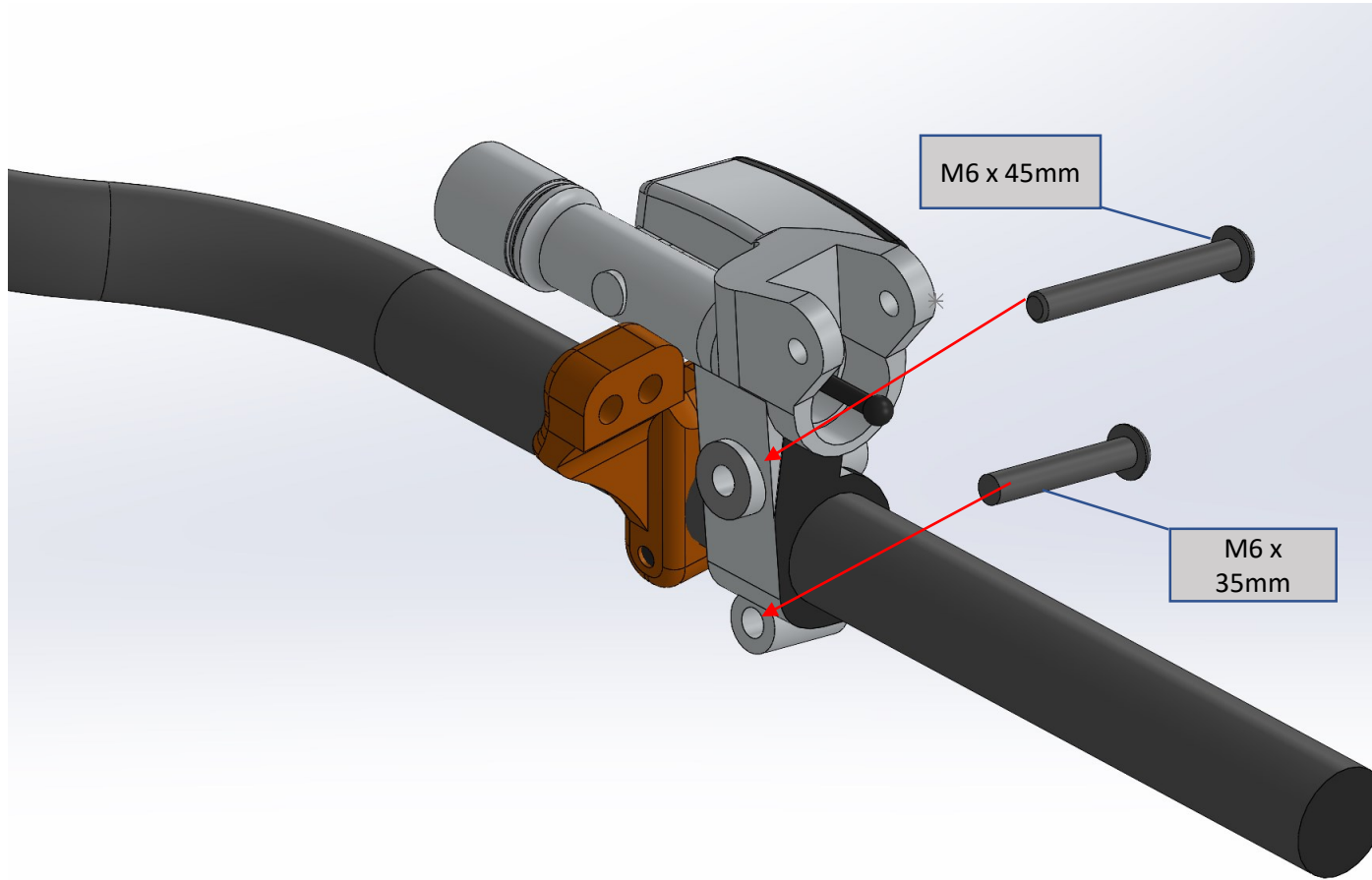

Grease the handle in all three interface points with master cylinder.

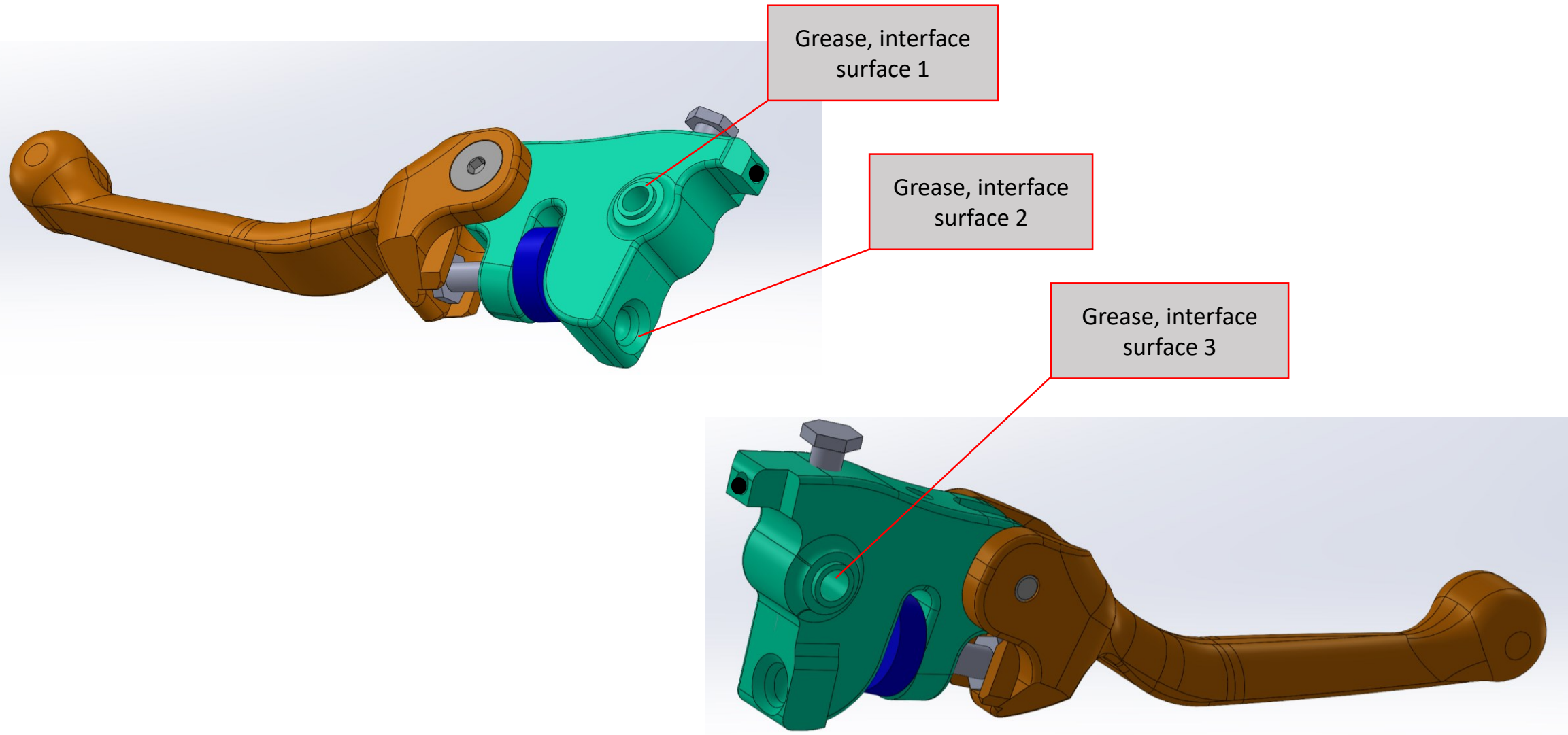

For wrap-around handguards, insert the bearing onto the shaft and follow the instructions. Please note that the illustrations in the instructions do not show the bearing being inserted (general note: the bearing is used as a spacer). However, if you are using an open handguard that mounts to the master cylinder, you do not need the bearing because the plastic adapter will fill the gap.

Larger flat surface of the bearing facing down

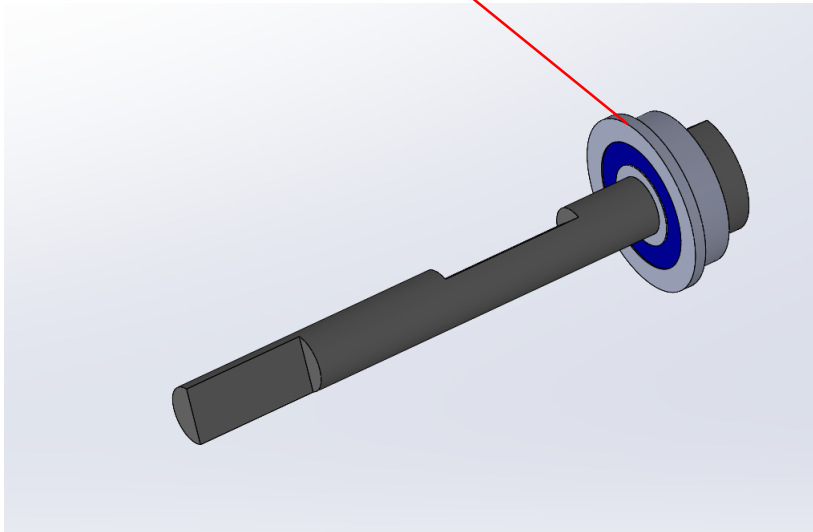

Wrap-around handguards no adapter on master cylinder



Open handguards with adapter on master cylinder (no bearing)





**Step 3:** Assemble handle with main shaft according to illustration and adjust “handle free play” with Allen key

\* Free play: make sure the handle is not pushing the pump piston while in resting position.

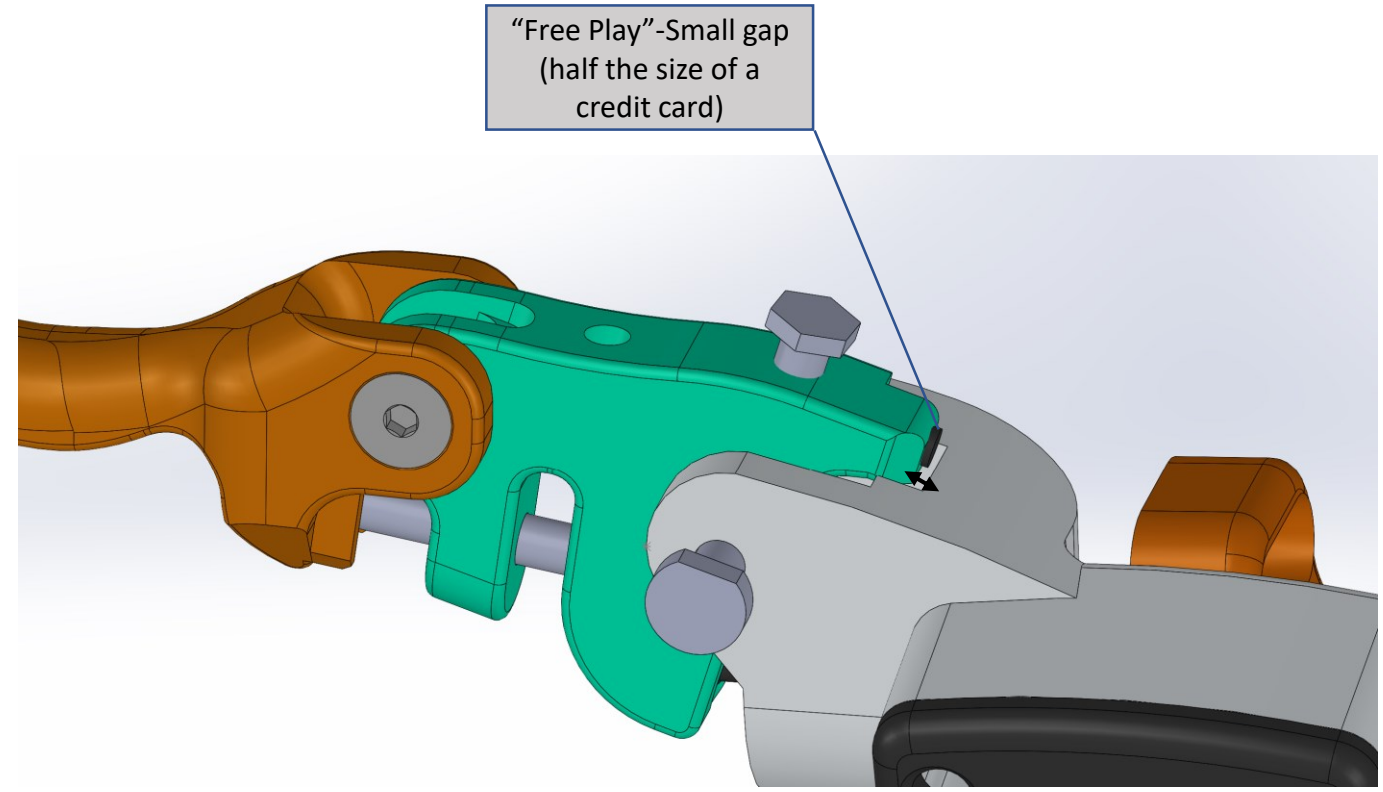
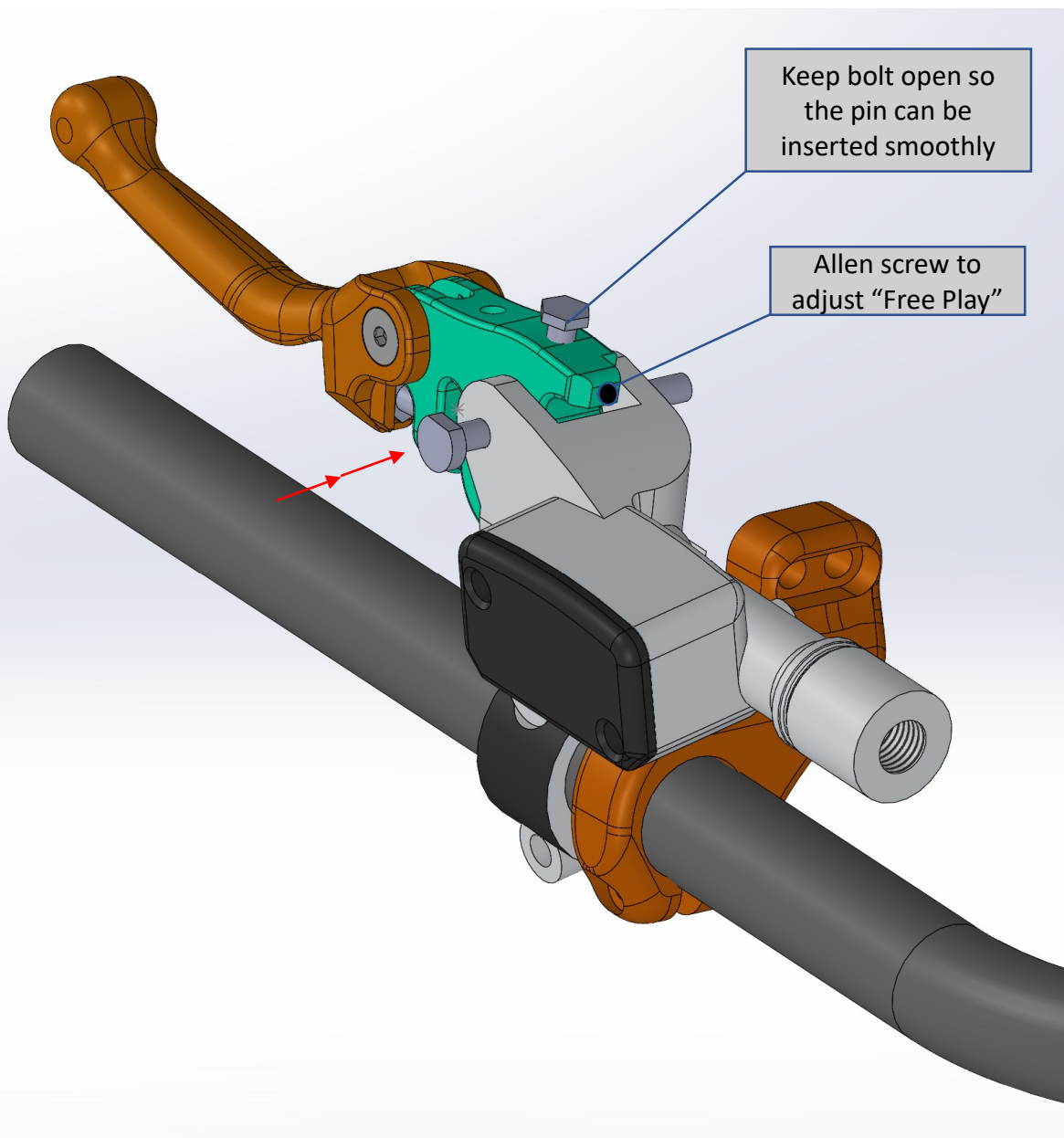



**Step 4:** "Install the large washer onto 45mm bolt. Then install the thin nut (non nyloc ) onto the lower M6 bolt per the illustration. **DO NOT** torque the nut against the master cylinder."

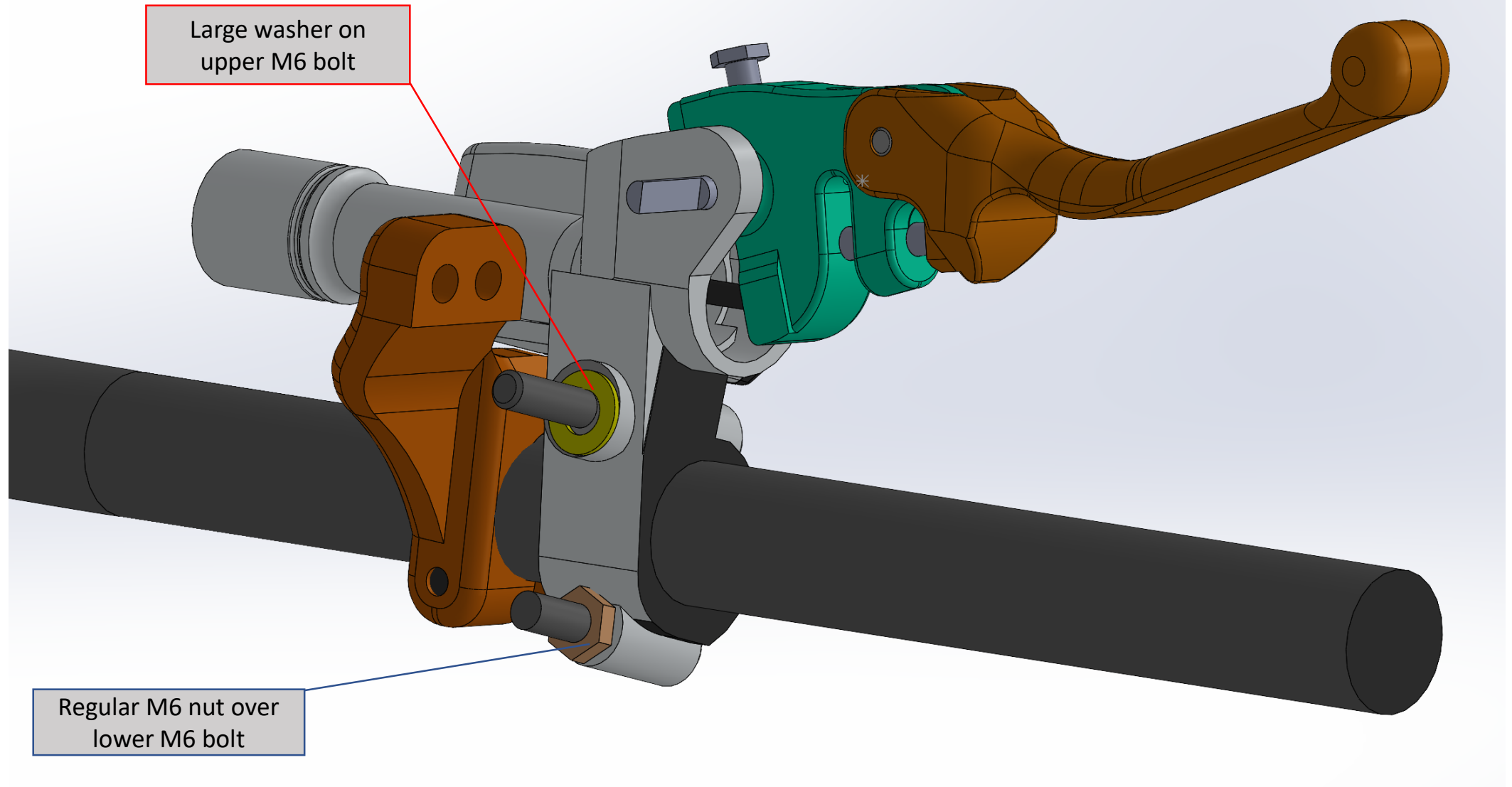

**Step 5:** Assemble lower housing according to illustration.

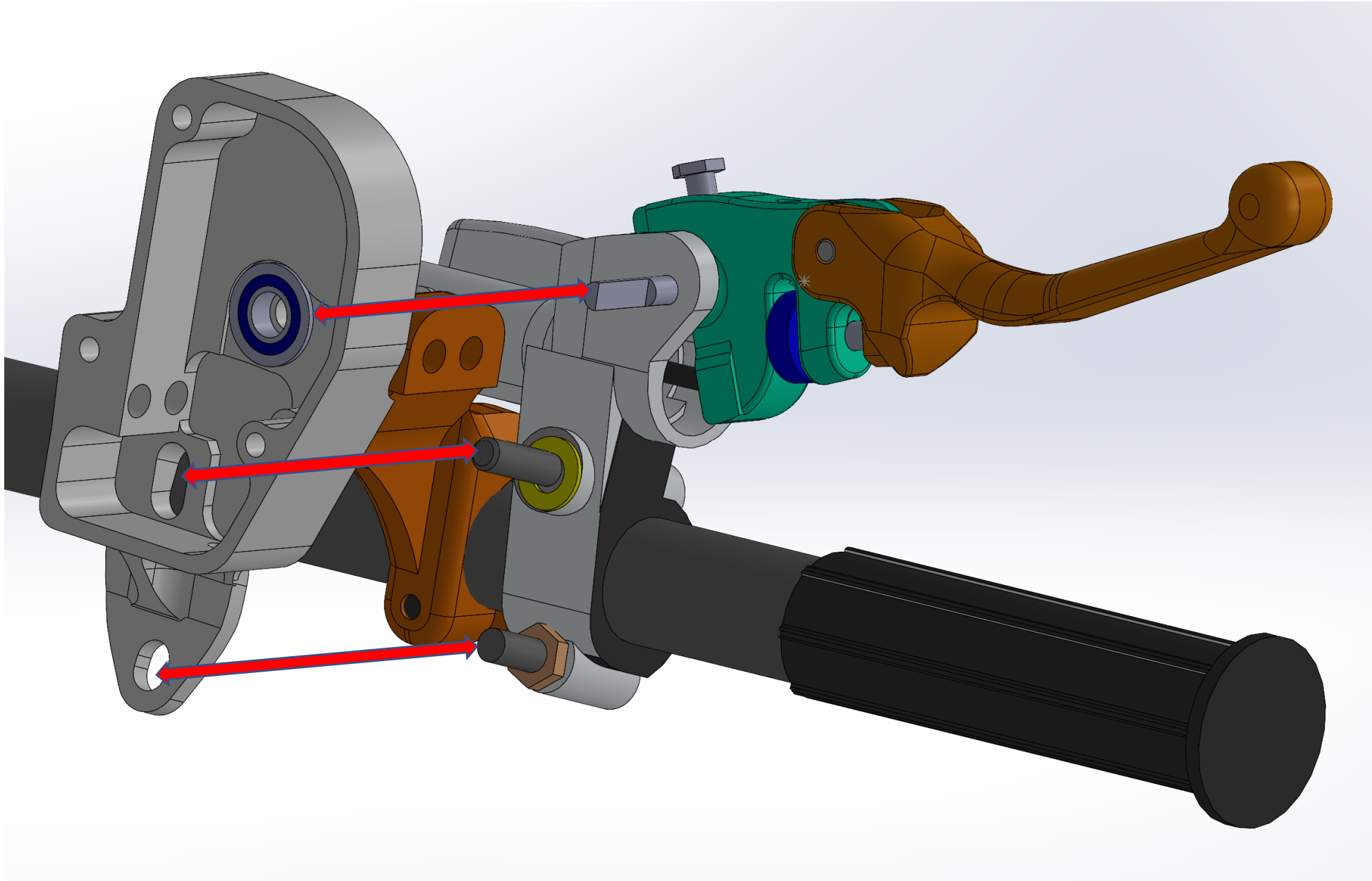

**Step 6:** Place small washer on front M6 bolt.

Small washer on upper  
M6 bolt

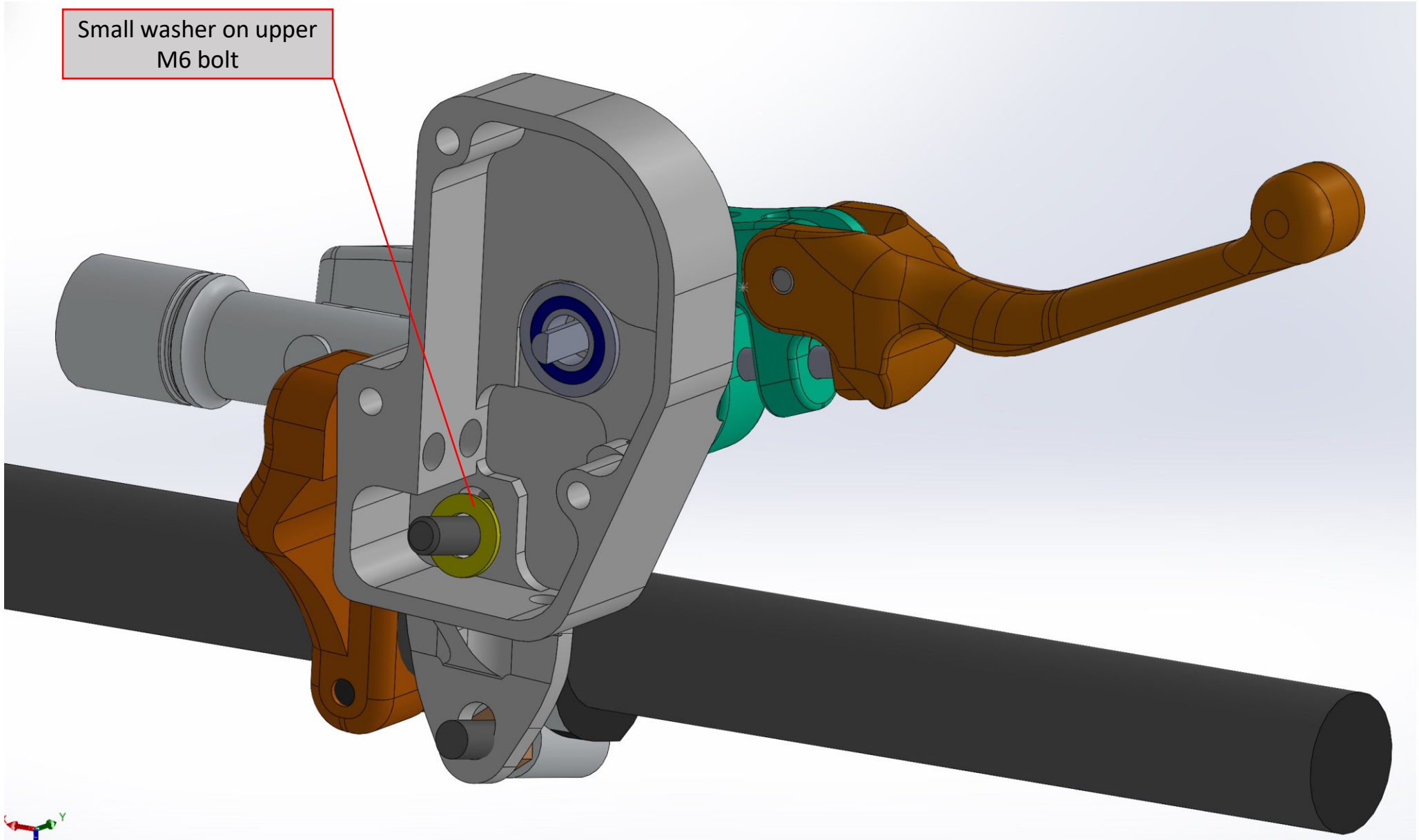

**Step 7:** Place the M6 Nyloc nuts over both M6 bolts, tighten the nuts so the lower housing is still loose and can move slightly.

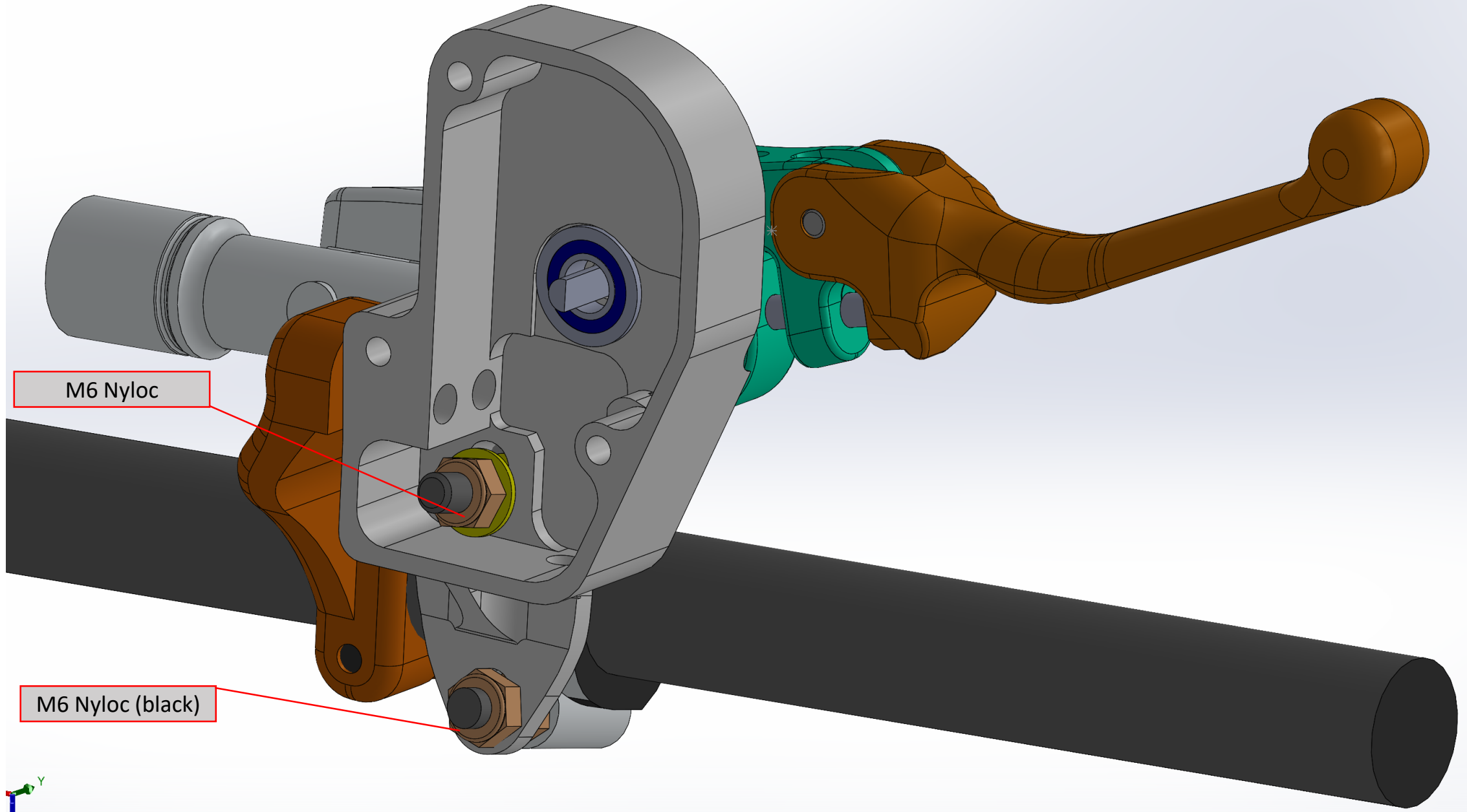

**Step 8:** Insert one M5 X 35 mm bolt into the handlebar adapter and lower housing and lightly tighten the Nyloc nut. Do not over tighten and keep the upper housing slightly loose.

Insert one M5 x 35 mm  
throughout handlebar  
adapter and into lower  
housing

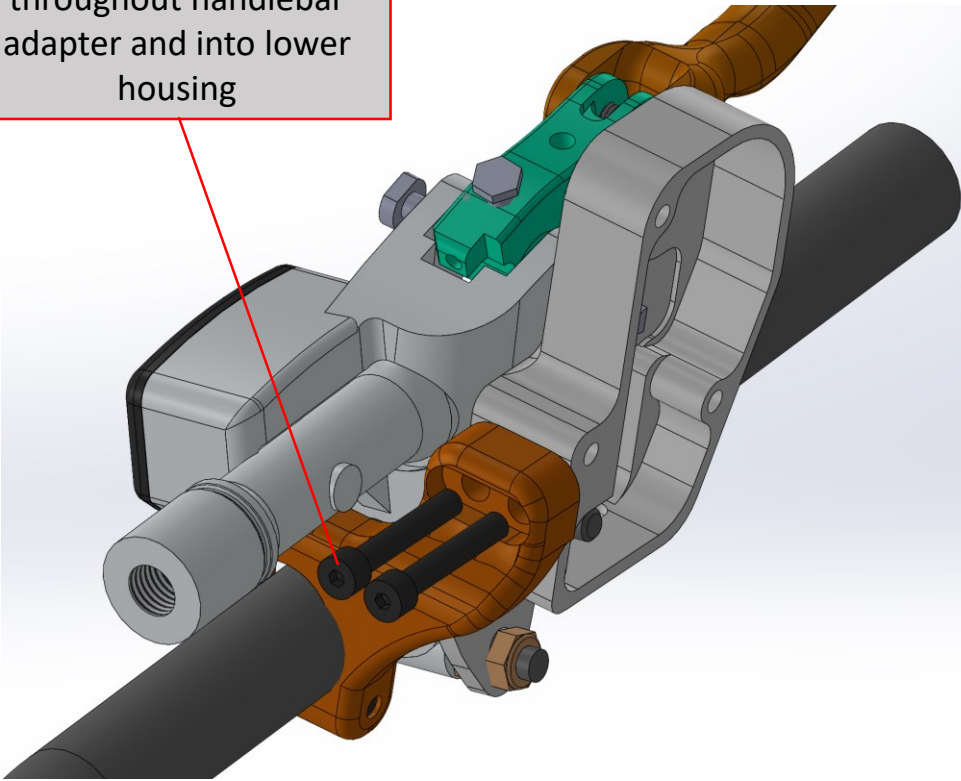

Use M5 Nyloc nut

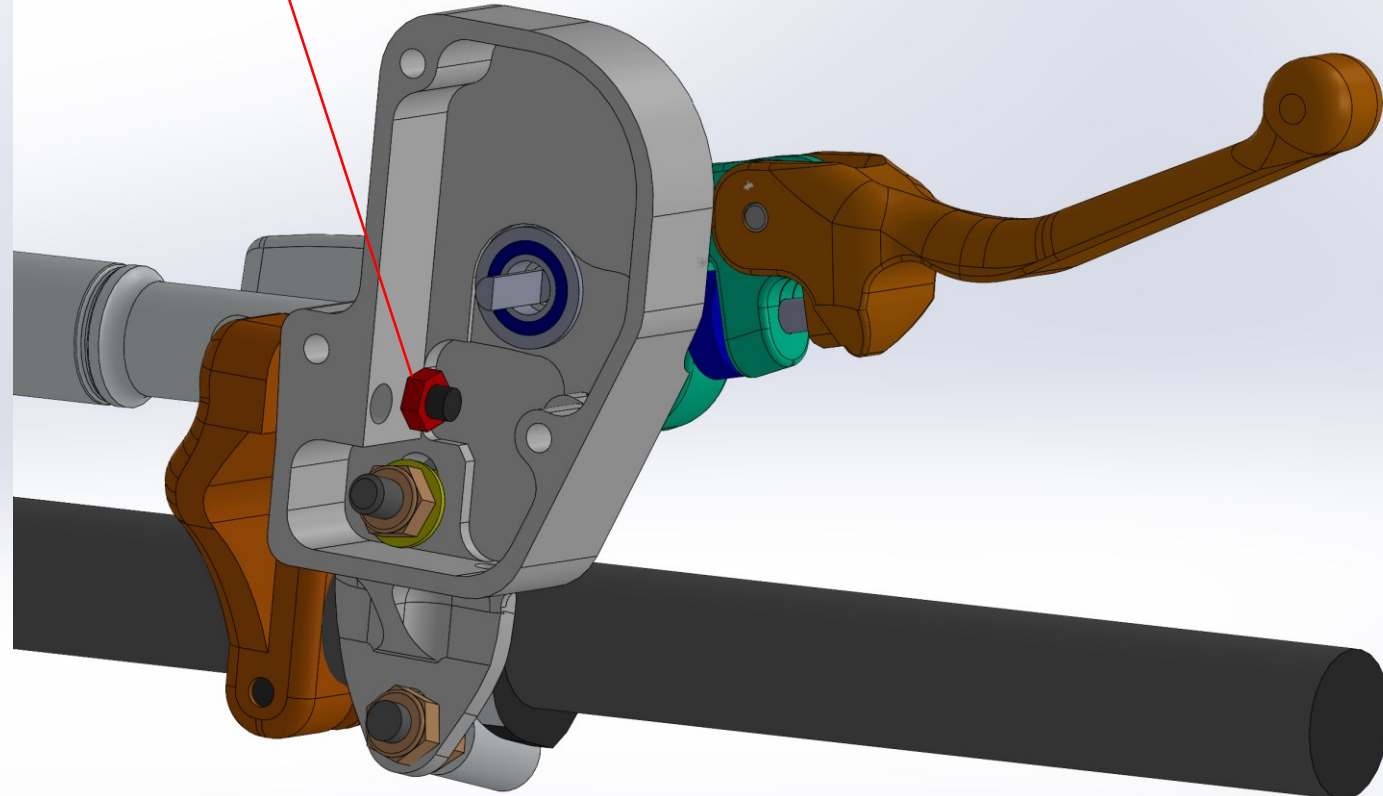



**Step 9:** Insert the linkage system over the main shaft while holding the shaft from the top.

Grease the spring to reduce corrosion

Make sure the bolt is open so it will not interfere with the insertion of the linkage over the shaft.

Make sure the housing is slightly loose so that the linkage assembly will fit over the shaft and inside the bearing

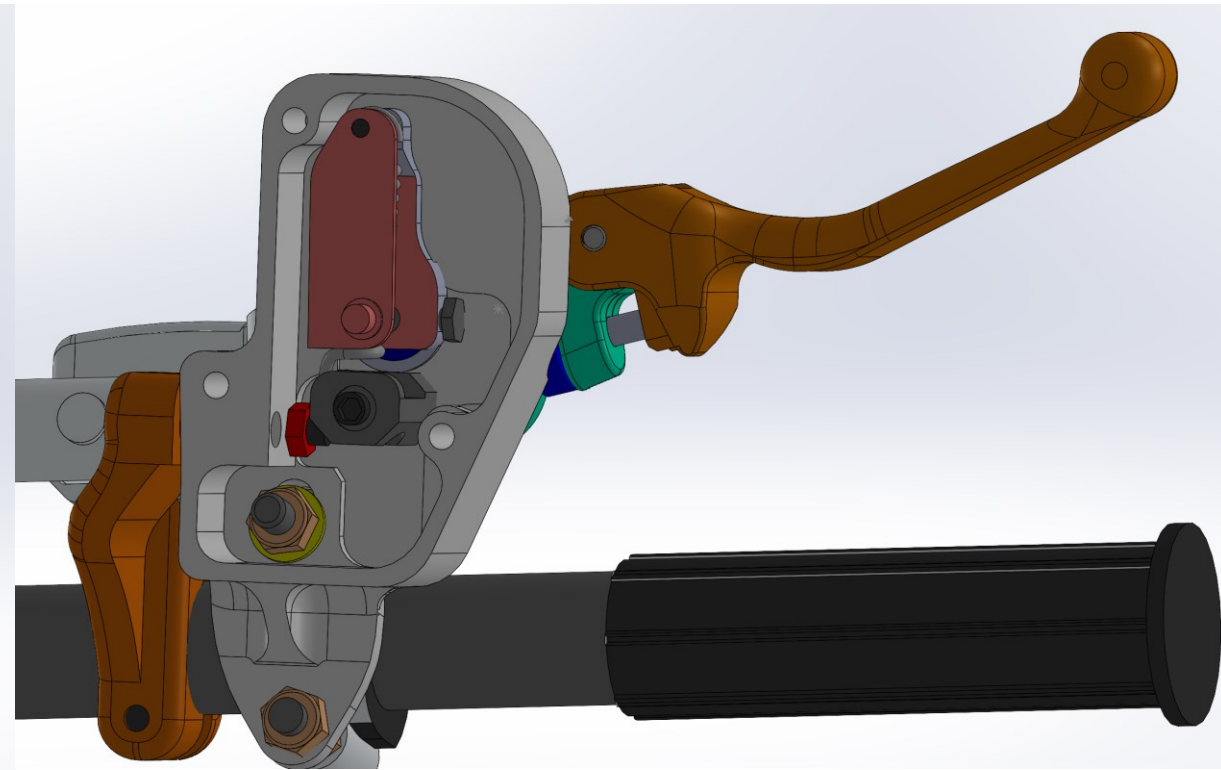
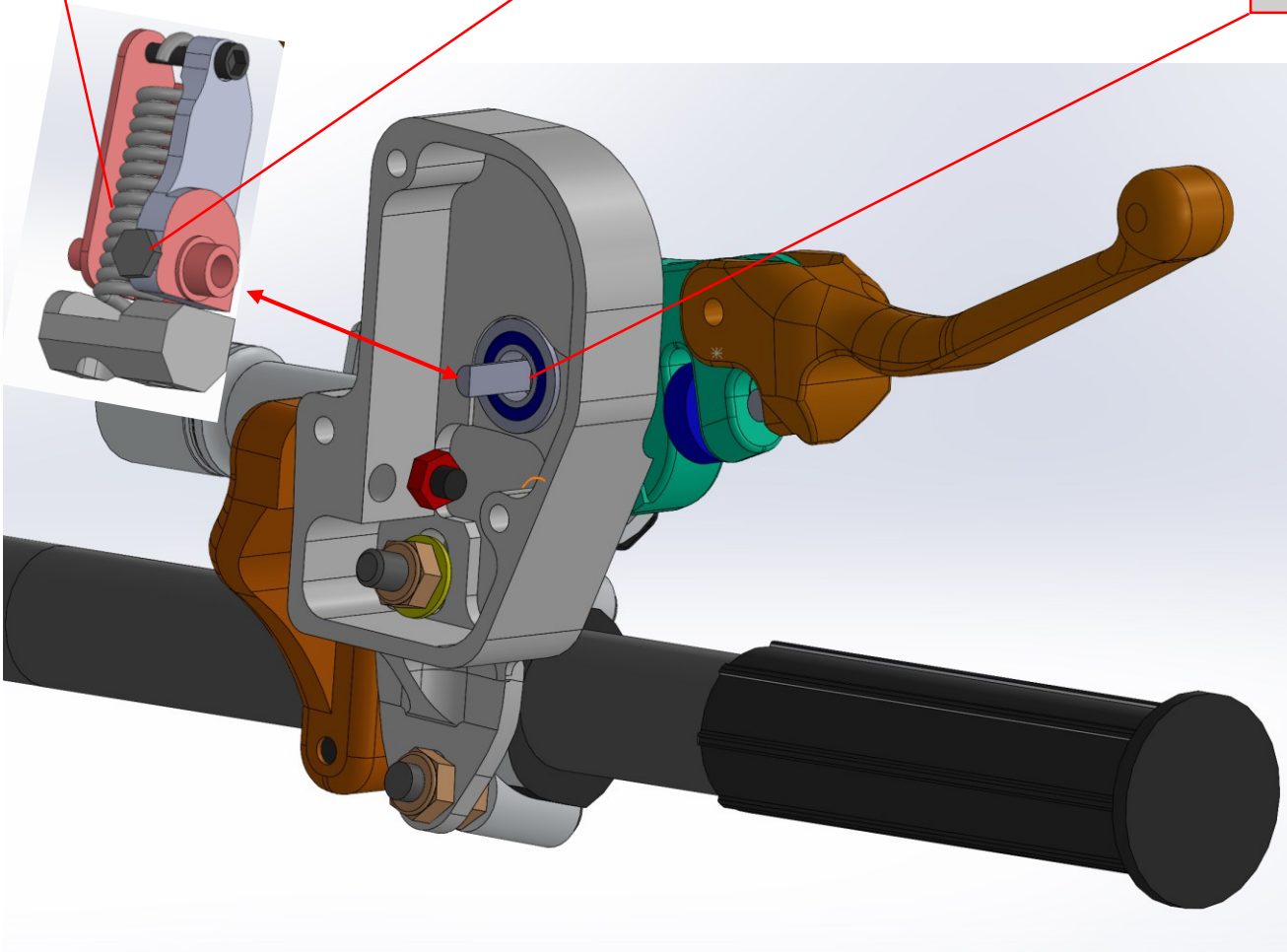



**Step 10:** Adjust the shaft height and orientation according to the illustration below.

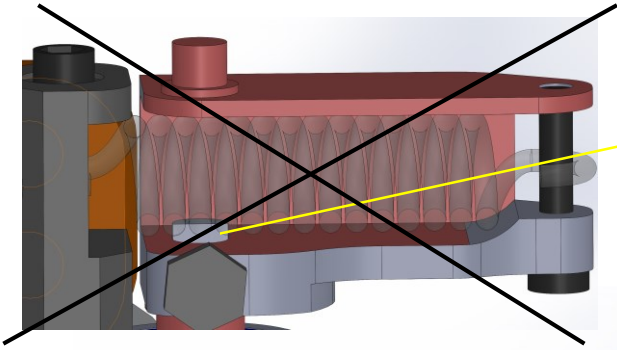

⚠ The shaft should not protrude like shown in this photo because it could interfere with spring!

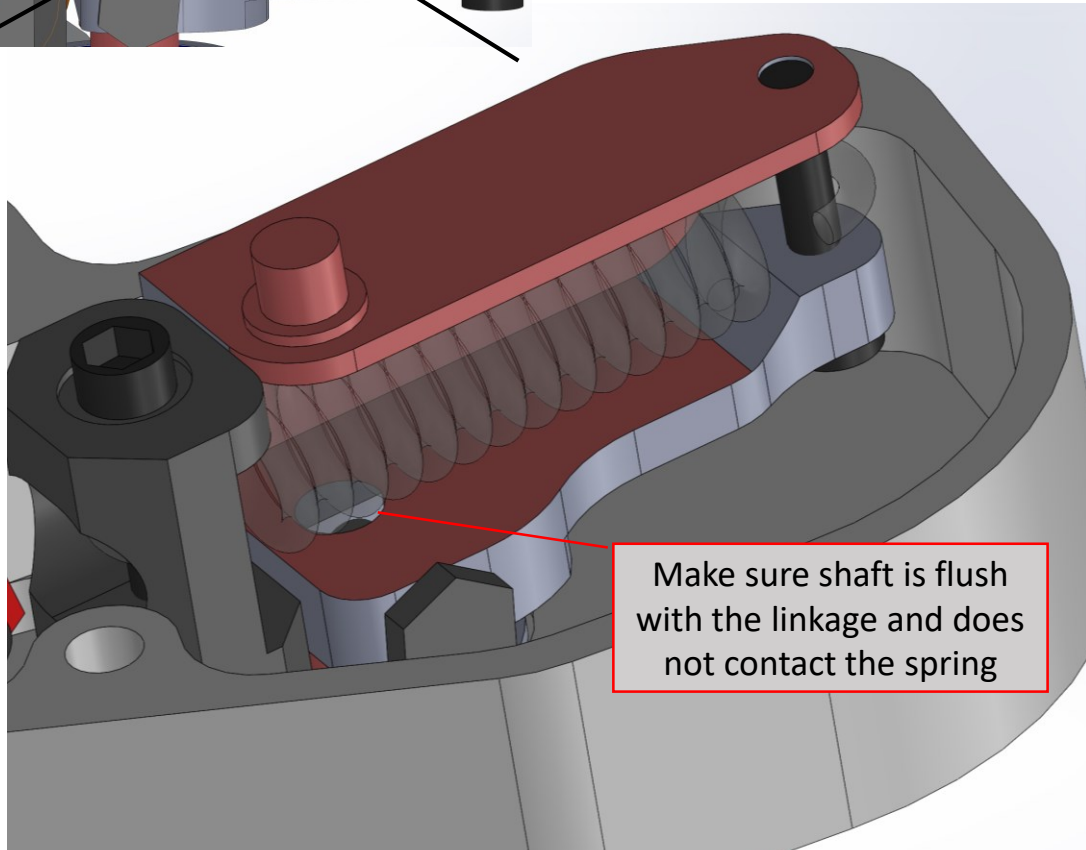

Make sure shaft is flush with the linkage and does not contact the spring

Make sure shaft is orientated with flat part to the bolt on the handle

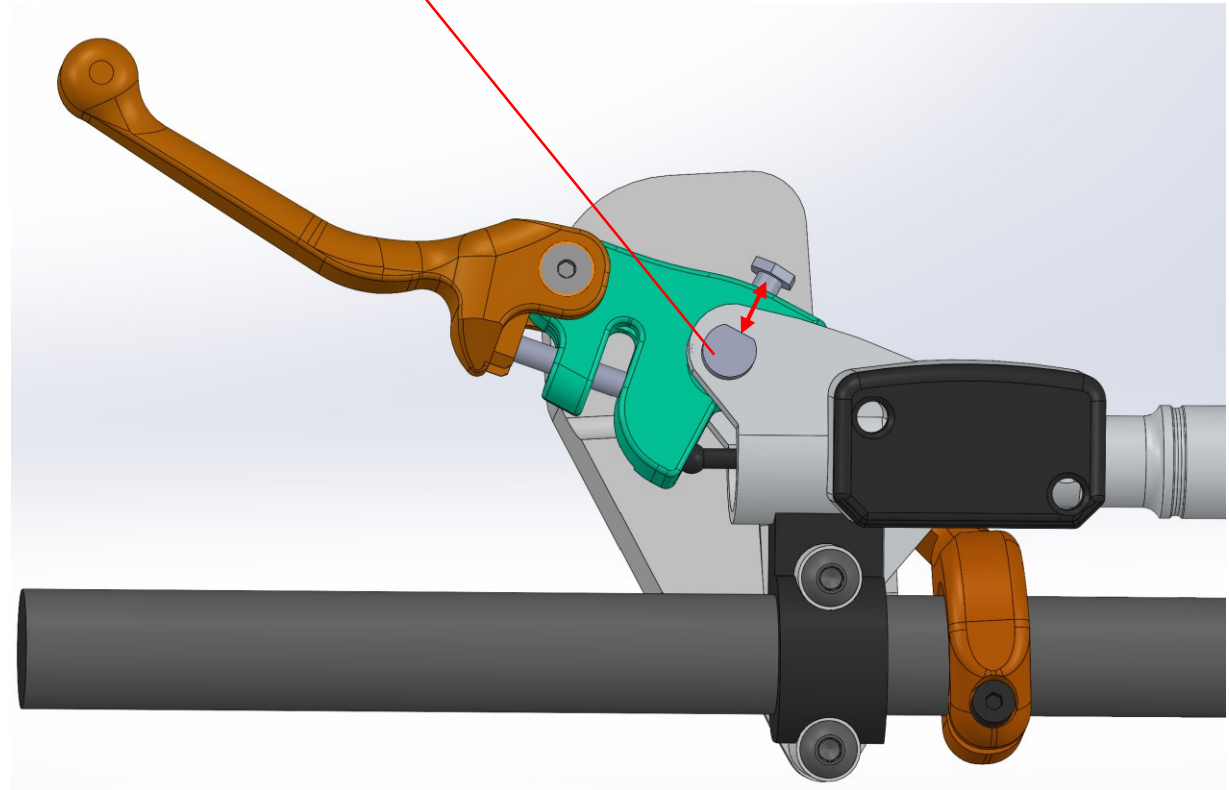

**Step 11:** Press the linkage on ensuring that it's fully inserted into the housing while tightening the bolt with the 7mm wrench.

Press firmly

Tighten the bolt firmly but do not over tighten. It is being threaded into aluminum so be cautious the force as to not strip the threads

Make sure housing and linkage are parallel

Make sure housing is touching the base of the lever assembly.

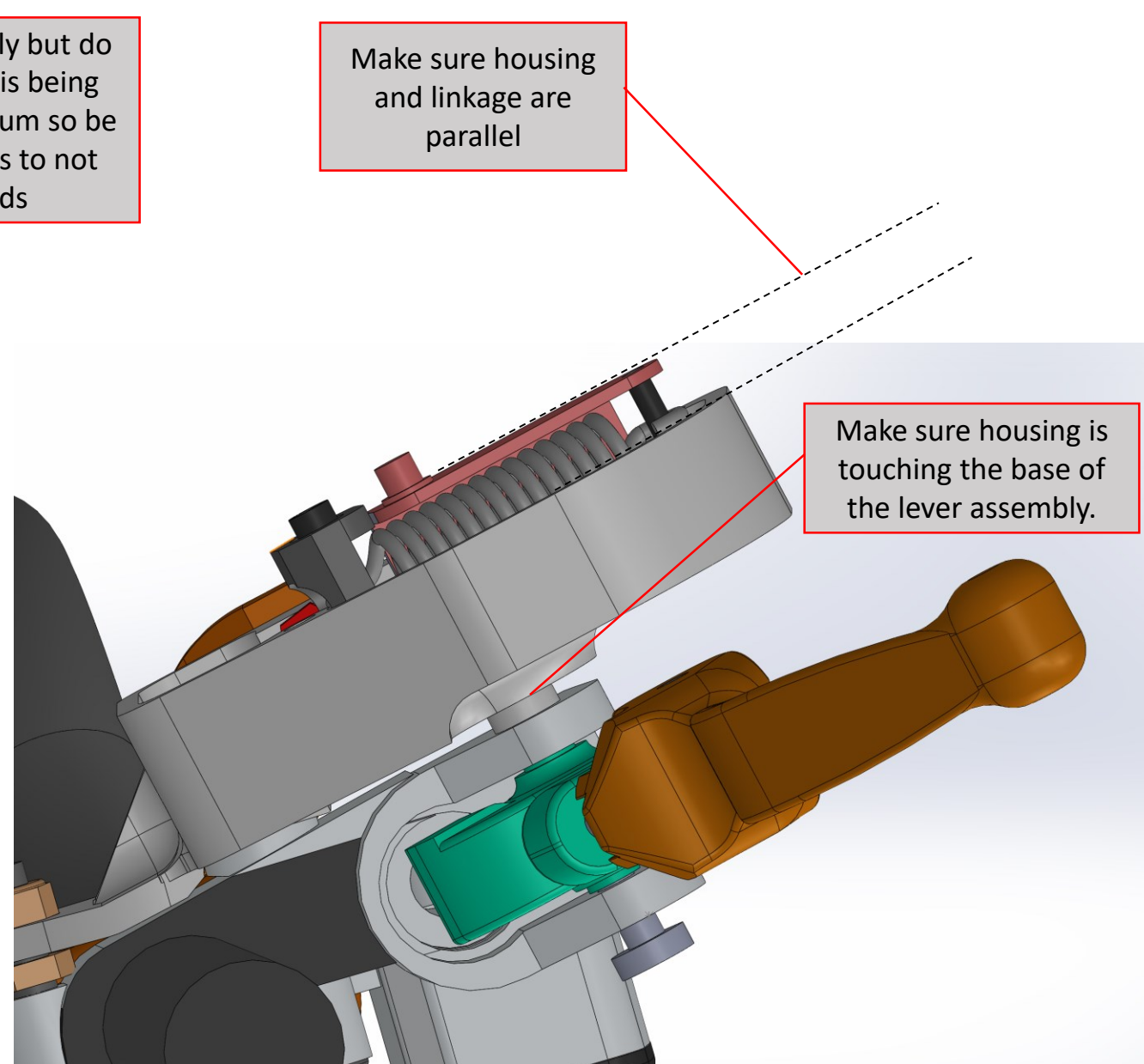
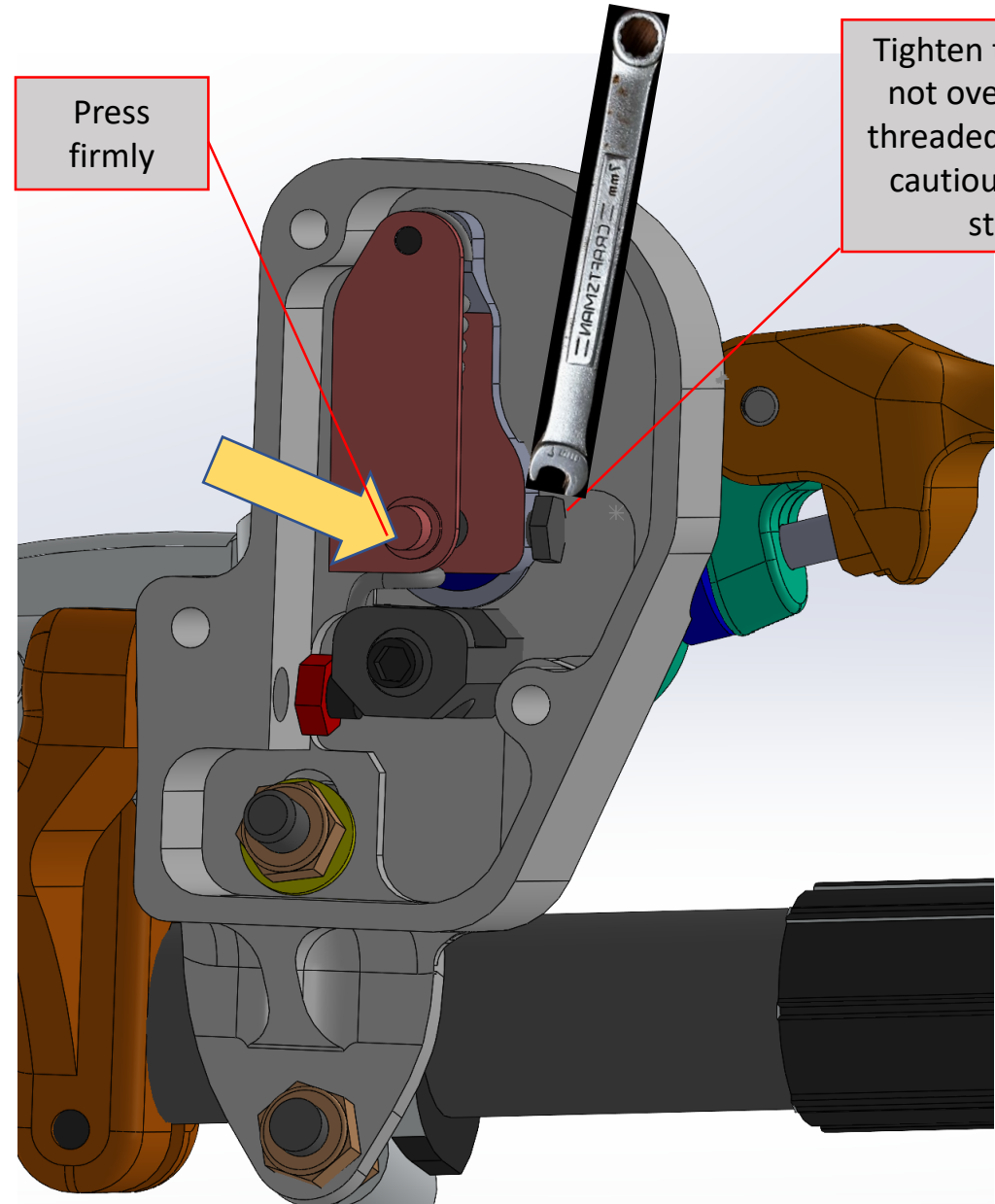

**Step 12:** Tighten the bolt with Allen key.

Make sure to tighten, so if applied force the entire clutch pump can rotate around the handlebar

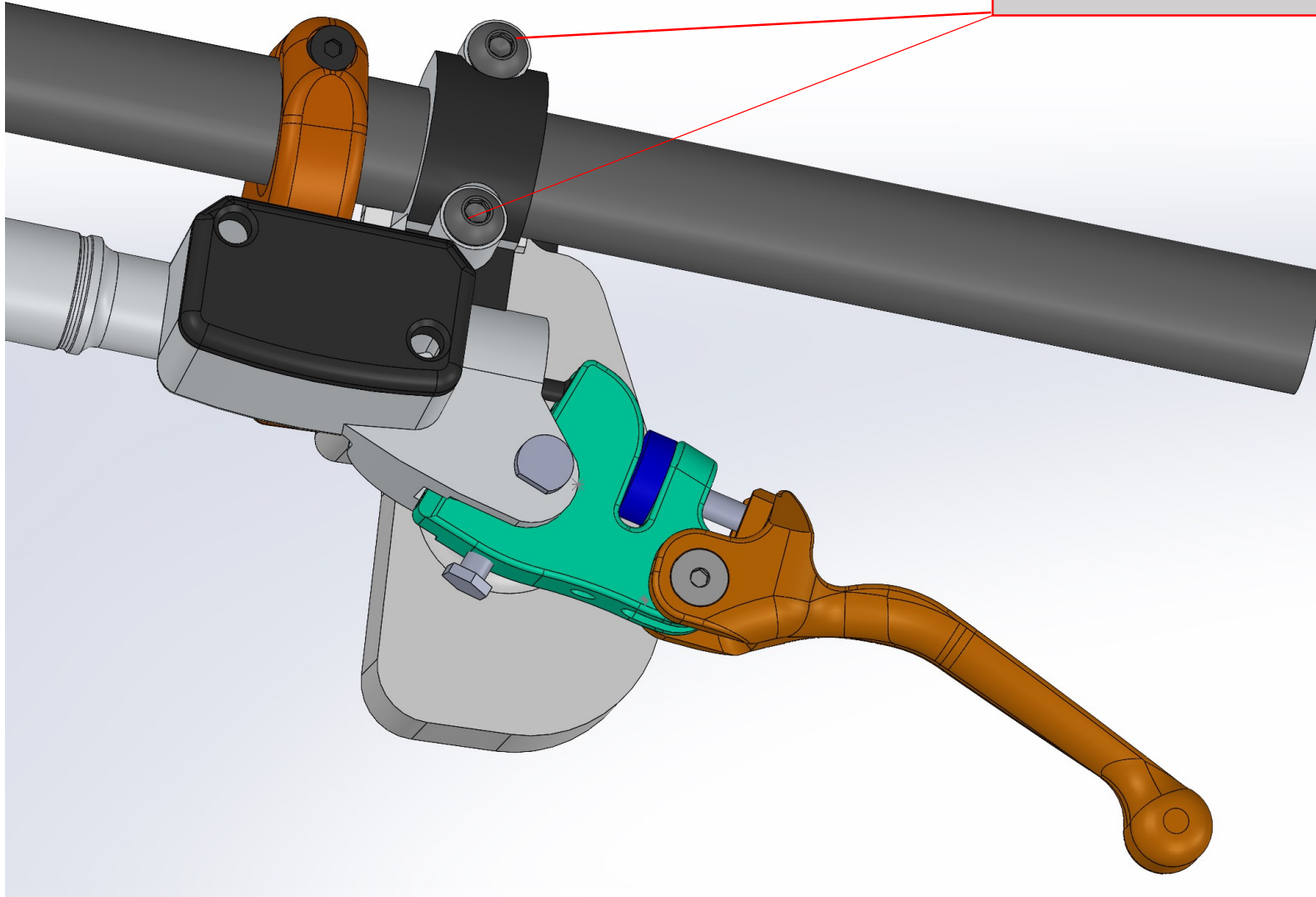

**Step 13:** tighten the M6 nuts in the following sequence of steps: 1, 2, 3

**Step 3:** Tighten the Nyloc nut (10mm socket) while holding the bolt in position with the Allen key. Do not rotate the Allen key, only the Nyloc nut.

**Step 2:** Tighten the Nyloc nut (10mm socket) while holding the bolt in position with the Allen key. Do not rotate the Allen key, only the Nyloc nut. Do not over tight

**Step 1:** Tighten the regular M6 nut so that it just contacts the housing, it should not move the housing and only acts as a stopper

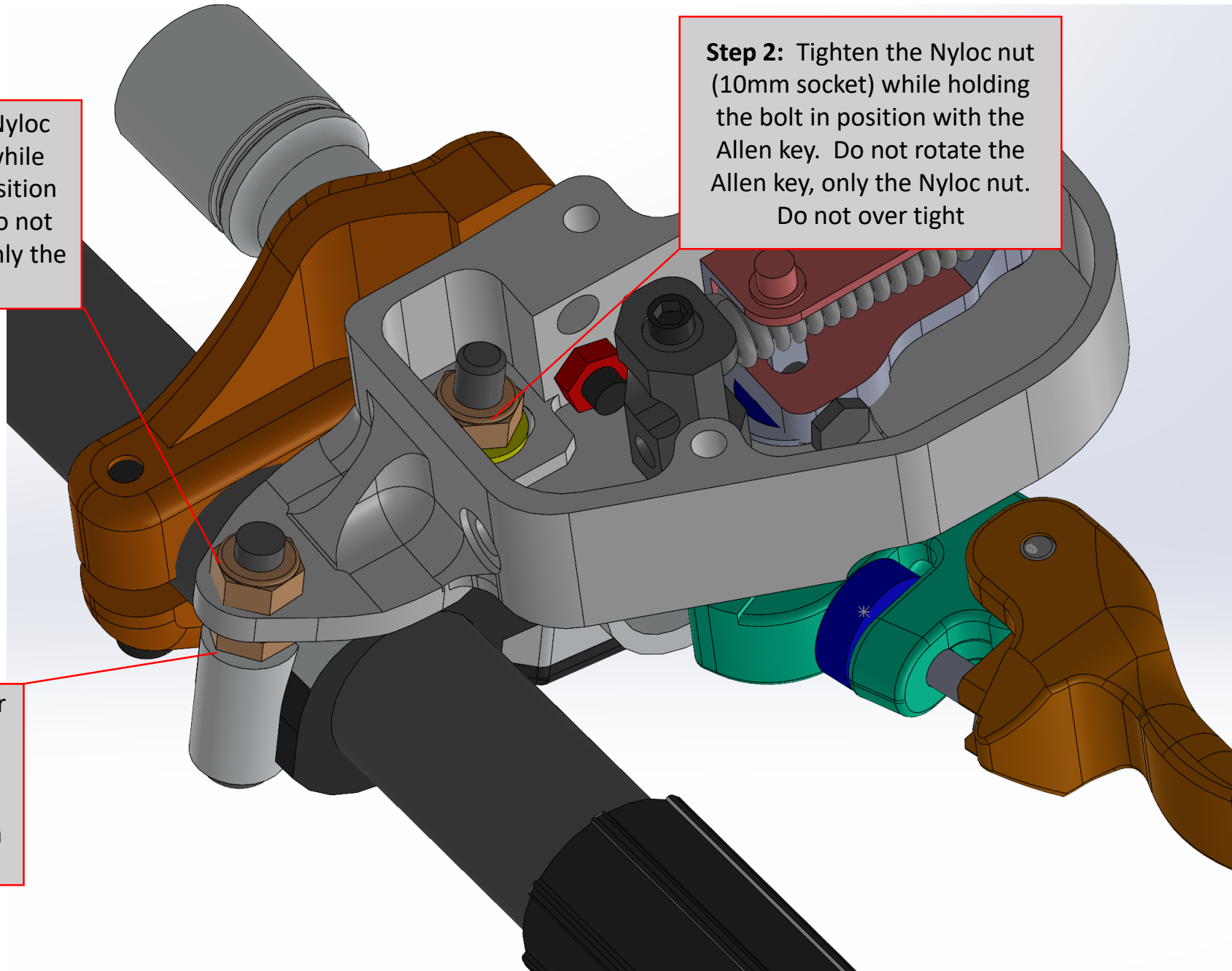



**Step 14:** Tighten the lower bolt first with 8mm wrench, then insert second bolt and tighten (do not over tighten).

Tighten the lower nut first

Insert second bolt and Nyloc nut and tighten

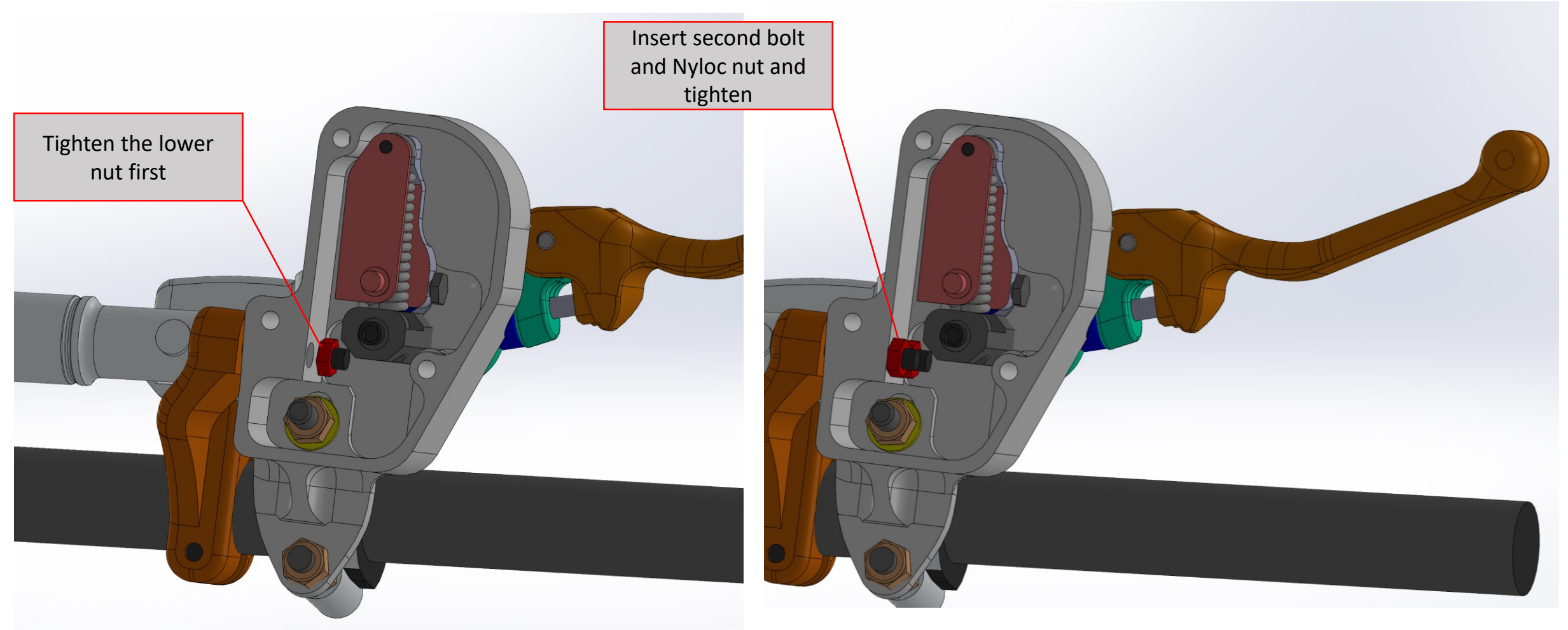

**Step 15:** Press the on linkage from other side and make sure it's fully inserted to housing while tightening the bolt with 8mm wrench.

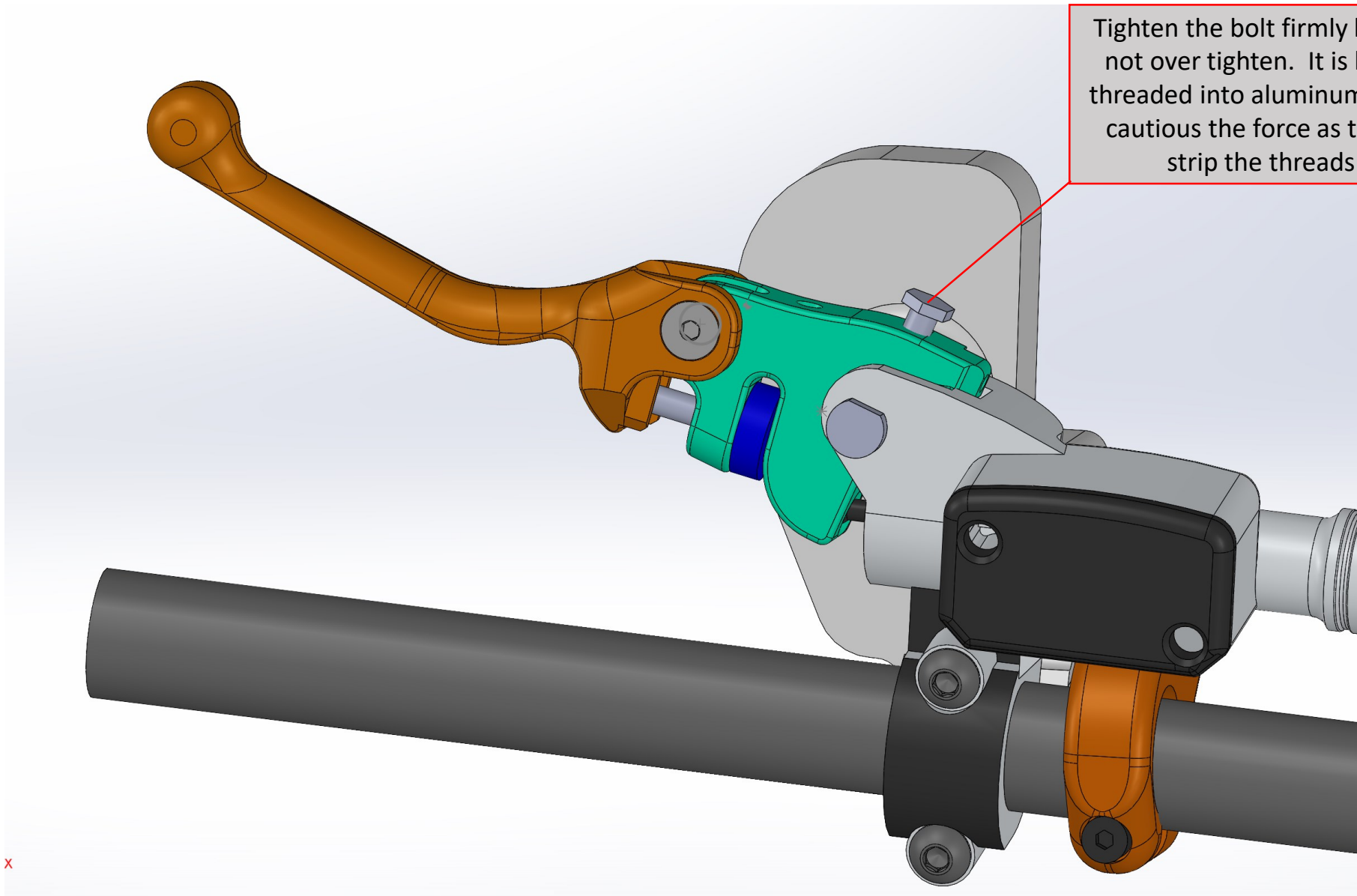

Tighten the bolt firmly but do not over tighten. It is being threaded into aluminum so be cautious the force as to not strip the threads



**Step 16:** Insert the M5 x 35mm bolt and make sure the spring puller is tilted towards the bolt so it will thread smoothly. Tighten by hand at first to ensure that you don't cross thread the bolt.

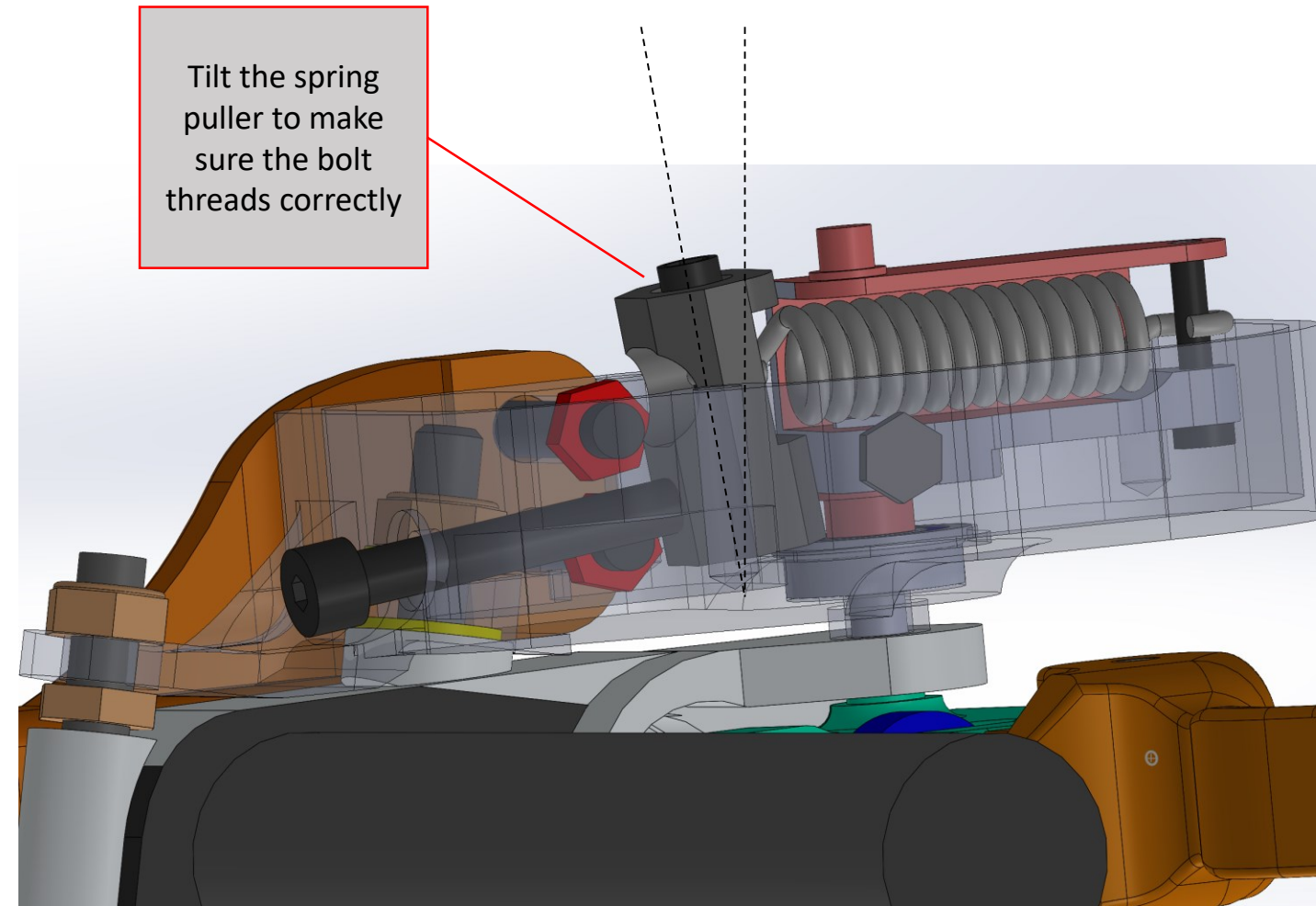
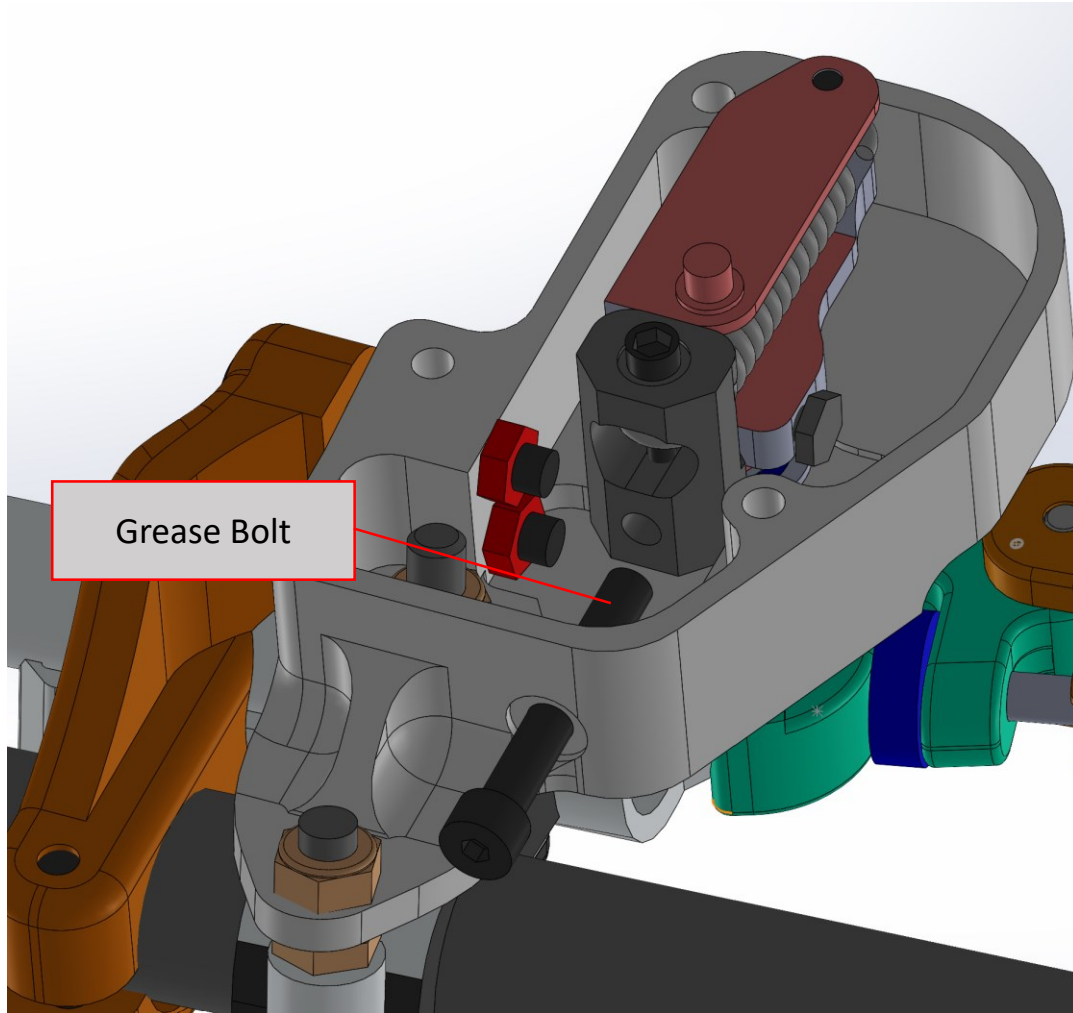

**Step 17:** Tighten Allen bolt until the spring puller slides down the small step and is now parallel with the housing.

Requires more tensioning

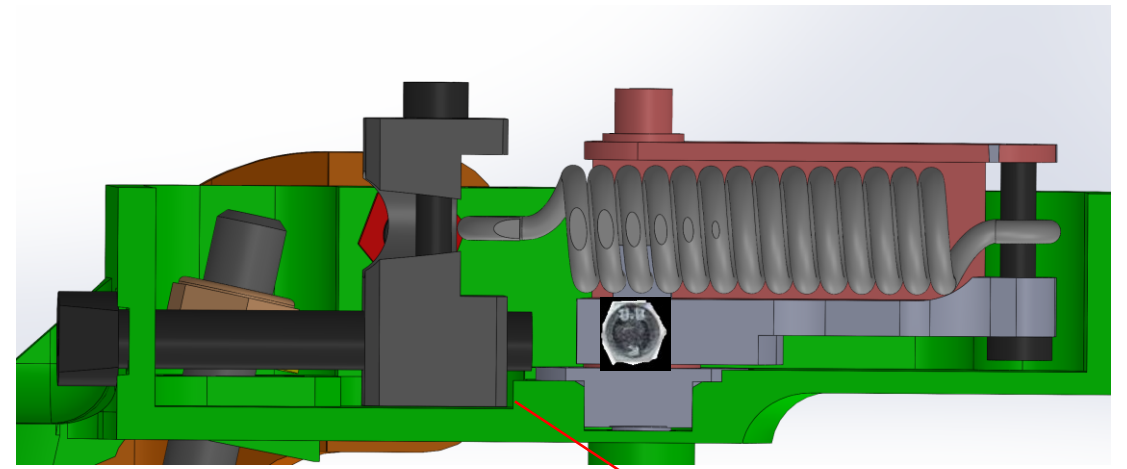
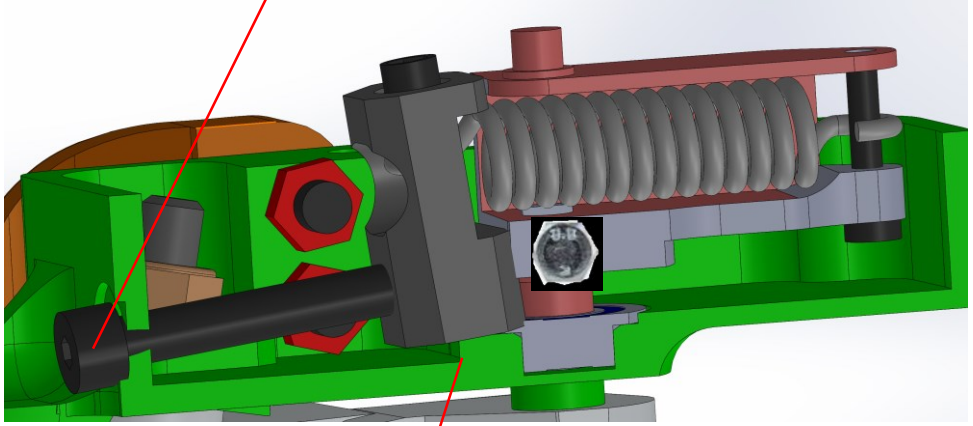

Correct position

Spring puller needs to slide down from this step

**Make sure the spring is located at the middle of spring older and their are no contact points between them.**

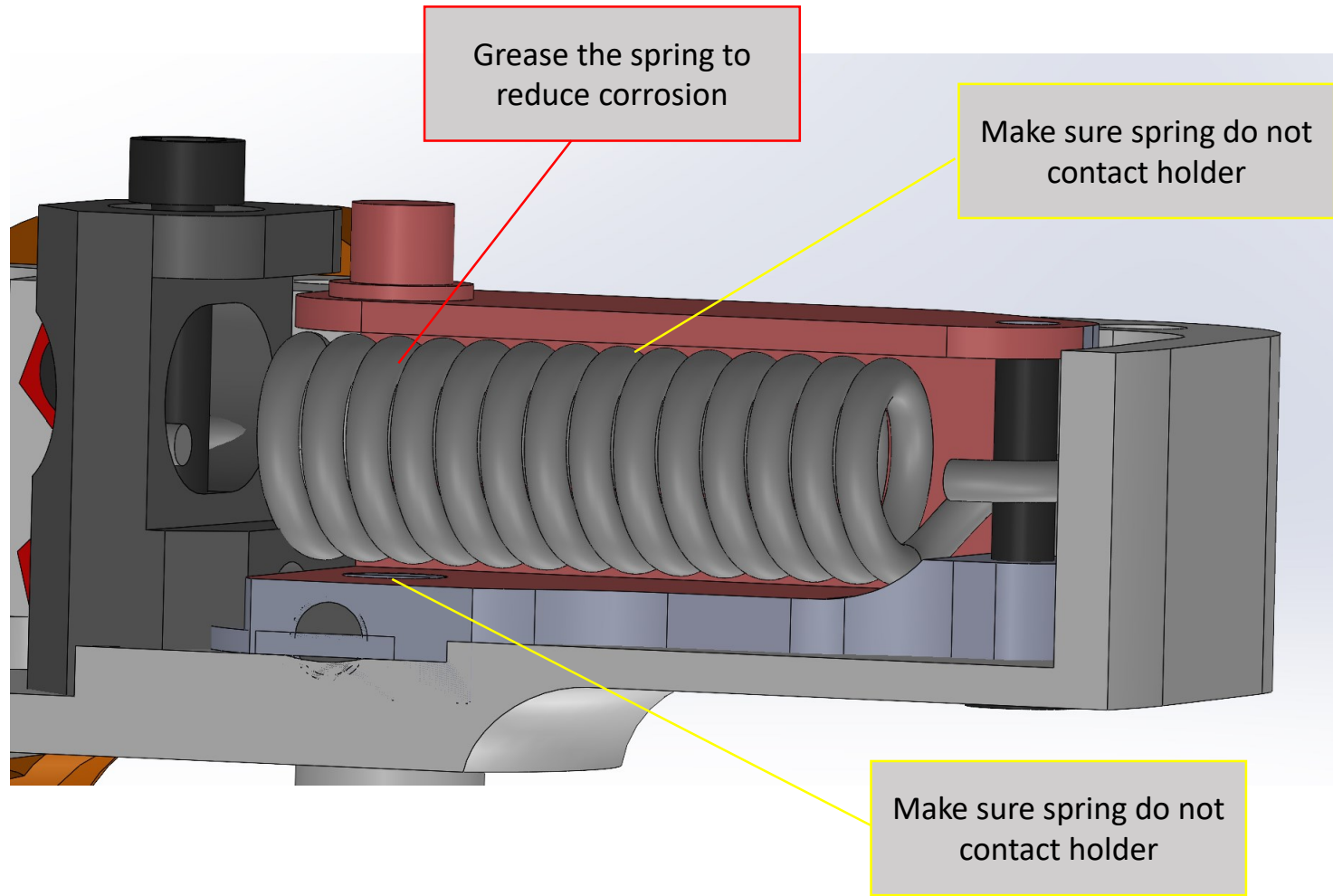

**Step 18:** Place the housing cover ensuring the bearing is centered over the linkage pin.

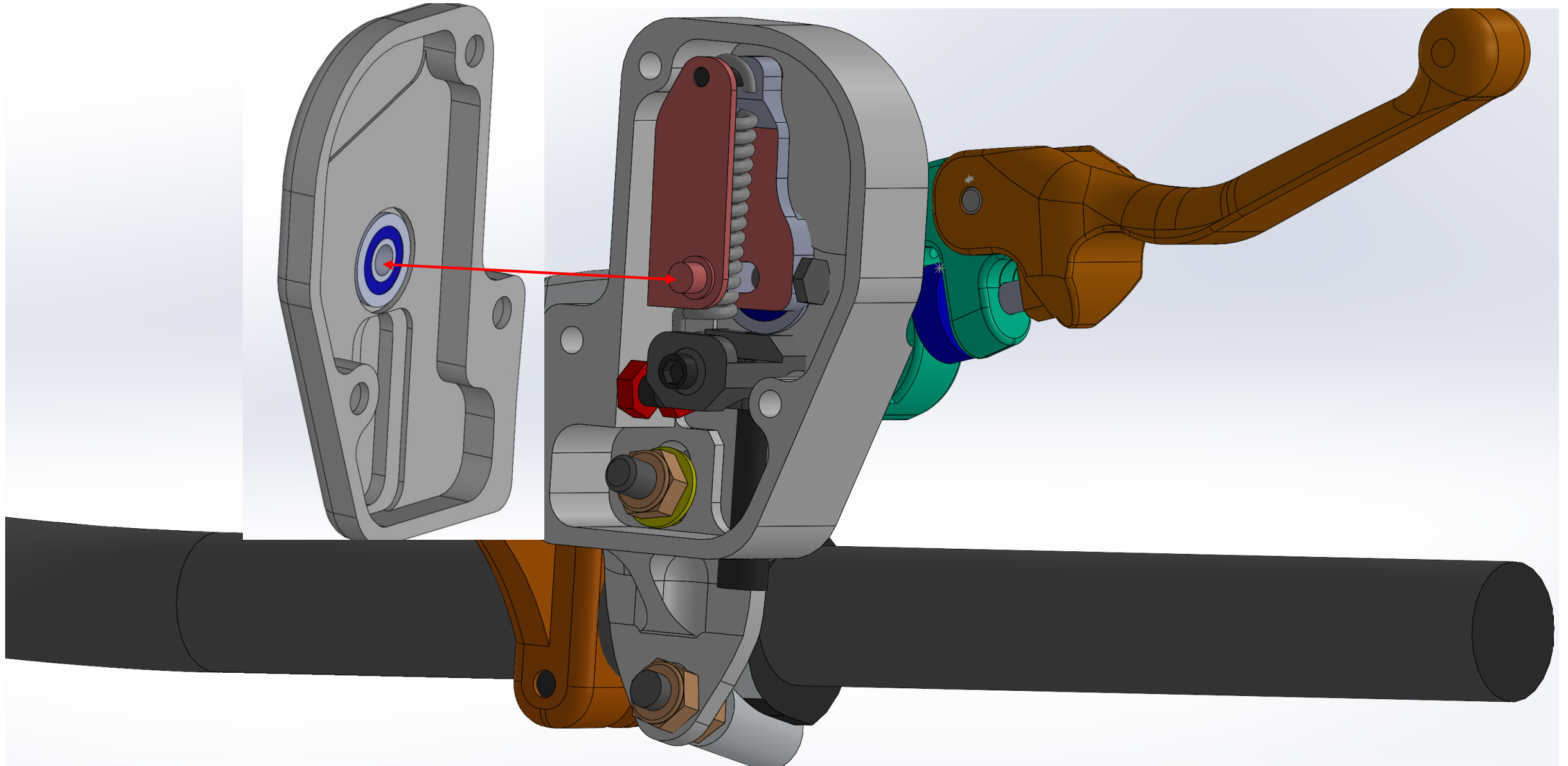

**Step 19:** Ensure that the cover is flush on all sides of the unit. You should not see any gapping (the bolts do not need to help close the gap).

Use Allen key to  
tight the bolts

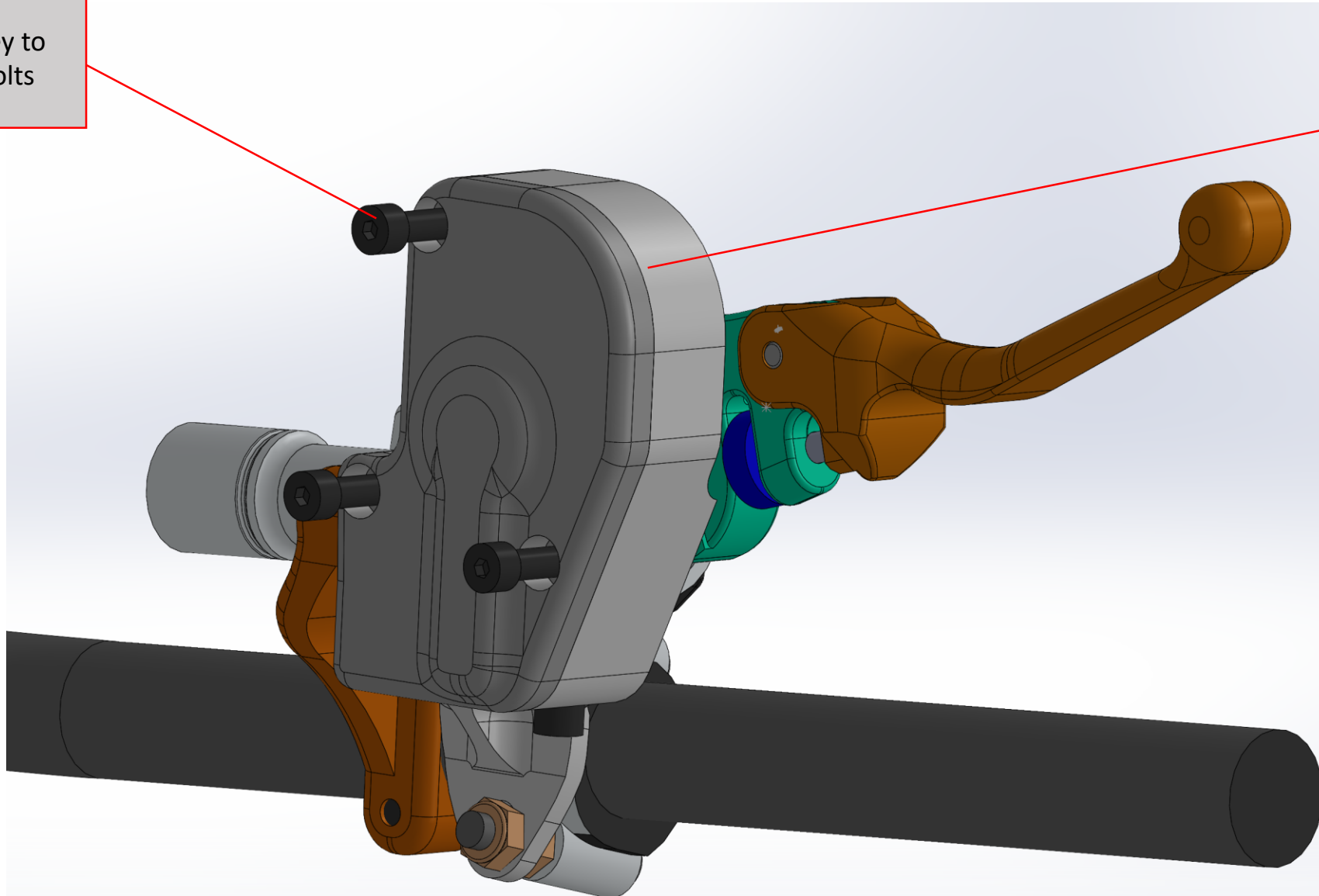

No gap identify before  
tightening the bolts (all  
around).  
If there is a gap please  
repeat step 11 and 12 to  
make sure linkage system is  
fully inserted to the  
housing.

**Step 20:** Tighten the 4mm Allen bolt clockwise until the pull is easy but natural and to the desired feel. If the clutch lever does not return after being pulled, back the Allen bolt out a couple of turns so that that lever returns freely and have a blast on your ride 😊.

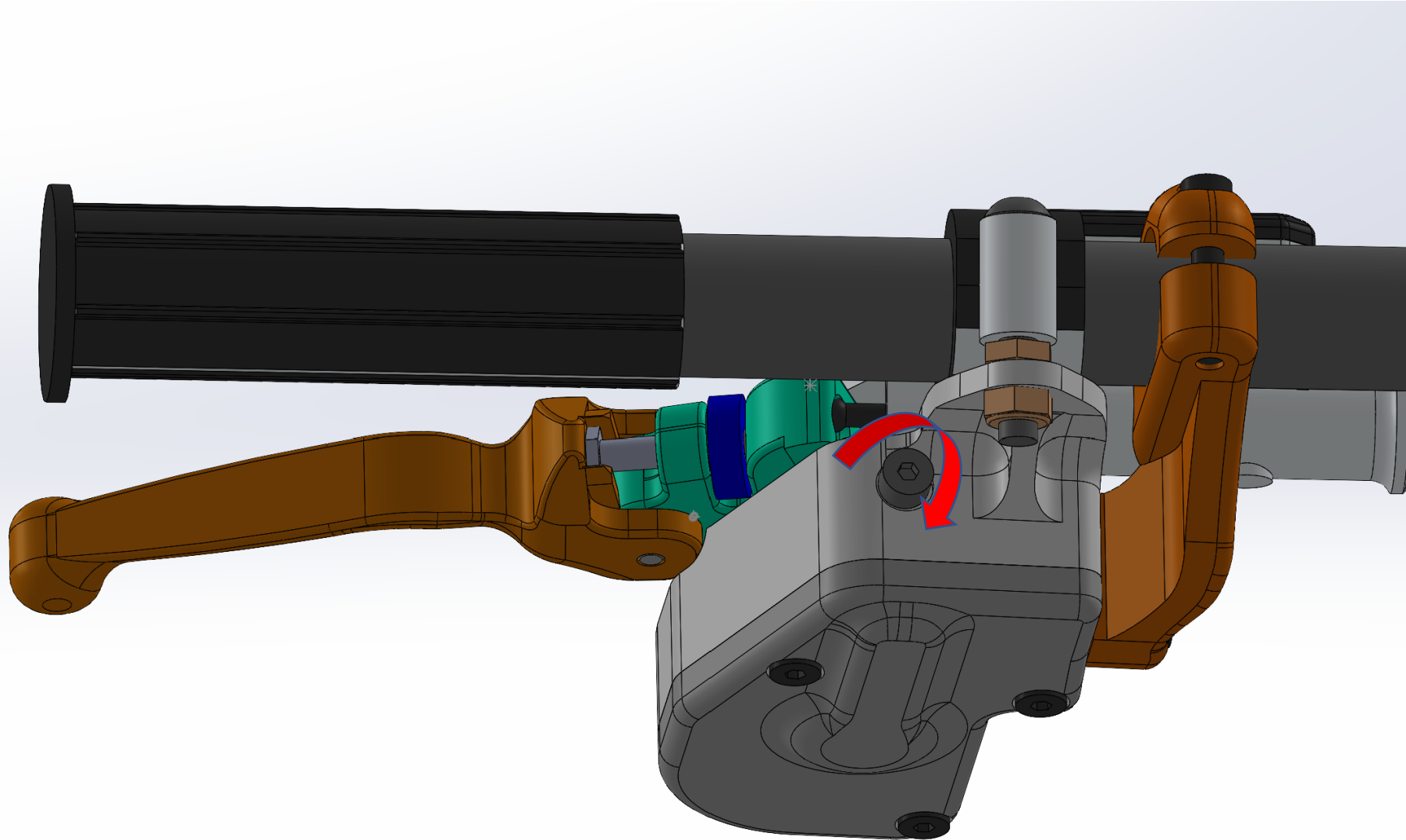



## Release of Liability Disclaimer for Aftermarket Off-Road Use Only, Clutch Assistance System

By installing and using the aftermarket off-road use only clutch assistance system (referred to as "Easy Clutch system"), you acknowledge and agree to the following terms:

- **Assumption of Risk:** You understand that the product is designed for off-road use only and may alter the functionality of the clutch system. The use of the product involves certain risks and hazards, including but not limited to the potential malfunction of the product, resulting in a non-functional clutch. You voluntarily assume all risks associated with the installation, use, and maintenance of the product.
- **Product Limitations:** You acknowledge that the product may not be suitable for all vehicles and that its performance can vary depending on factors such as vehicle condition, modifications, and maintenance. It is your responsibility to ensure the product is compatible with your vehicle and meets your specific needs.
- **Proper Installation and Maintenance:** You agree to follow all instructions provided by the manufacturer for the installation, use, and maintenance of the product. Any failure to comply with these instructions may result in product malfunction and subsequent clutch system issues.
- **Release of Liability:** In consideration for being permitted to use the product, you hereby release, discharge, and hold harmless the manufacturer, distributors, retailers, and their respective employees, agents, and affiliates from any and all claims, liabilities, damages, losses, or expenses arising out of or in connection with the installation, use, or performance of the product, including but not limited to any malfunctions, accidents, injuries, or damage to property.
- **Indemnification:** You agree to indemnify and hold harmless the manufacturer, distributors, retailers, and their respective employees, agents, and affiliates from any claims, actions, damages, liabilities, or expenses (including legal fees) arising from your use of the product, including any claims brought by third parties.
- **No Warranty:** The product is provided "as is" without any warranties, expressed or implied. The manufacturer, distributors, and retailers disclaim any warranties of merchantability, fitness for a particular purpose, or non-infringement. You acknowledge that the product may not always operate as intended and that no guarantees are made regarding its performance or reliability.
- **Governing Law:** This release of liability disclaimer shall be governed by and construed in accordance with the laws of Arizona. Any disputes arising from this disclaimer shall be subject to the exclusive jurisdiction of the courts in Arizona.

By installing and using the product, you confirm that you have read and understood this release of liability disclaimer and agree to be bound by its terms.